

STATE OF TEXAS
COUNTY OF HARRIS

WE, THE WOODLANDS LAND DEVELOPMENT COMPANY, L.P., A TEXAS LIMITED PARTNERSHIP, ACTING BY AND THROUGH TIM WELBES, AUTHORIZED REPRESENTATIVE OF THE WOODLANDS LAND DEVELOPMENT COMPANY, L.P., A TEXAS LIMITED PARTNERSHIP, OWNERS HEREINAFTER REFERRED TO AS OWNERS OF THE 24.137 ACRE TRACT DESCRIBED IN THE ABOVE AND FOREGOING MAP OF THE WOODLANDS CREEKSIDE PARK WEST SEC 20, DO HEREBY MAKE AND ESTABLISH SAID SUBDIVISION AND DEVELOPMENT PLAN OF SAID PROPERTY ACCORDING TO ALL LINES, DEDICATIONS, RESTRICTIONS, AND NOTATIONS ON SAID MAPS OR PLAT AND HEREBY DEDICATE TO THE USE OF THE PUBLIC FOREVER, ALL STREETS (EXCEPT THOSE STREETS DESIGNATED AS PRIVATE STREETS OR PERMANENT ACCESS EASEMENTS), ALLEYS, PARKS, WATER COURSES, DRAINS, EASEMENTS AND PUBLIC PLACES SHOWN THEREON FOR THE PURPOSES AND CONSIDERATIONS THEREIN EXPRESSED; AND DO HEREBY BIND OURSELVES, OUR HEIRS, SUCCESSORS AND ASSIGNS TO WARRANT AND FOREVER DEFEND THE TITLE ON THE LAND SO DEDICATED.

FURTHER, OWNERS HAVE DEDICATED AND BY THESE PRESENTS DO DEDICATE TO THE USE OF THE PUBLIC FOR PUBLIC UTILITY PURPOSE FOREVER UNOBSTRUCTED AERIAL EASEMENTS. THE AERIAL EASEMENTS SHALL EXTEND HORIZONTALLY AN ADDITIONAL ELEVEN FEET, SIX INCHES (11' 6") FOR TEN FEET (10' 0") PERIMETER GROUND EASEMENTS OR SEVEN FEET, SIX INCHES (7' 6") FOR FOURTEEN FEET (14' 0") PERIMETER GROUND EASEMENTS OR FIVE FEET, SIX INCHES (5' 6") FOR SIXTEEN FEET (16' 0") PERIMETER GROUND EASEMENTS, FROM A PLANE SIXTEEN FEET (16' 0") ABOVE THE GROUND LEVEL UPWARD, LOCATED ADJACENT TO AND ADJOINING SAID PUBLIC UTILITY EASEMENTS THAT ARE DESIGNATED WITH AERIAL EASEMENTS (U.E. AND A.E.) AS INDICATED AND DEPICTED HEREON, WHEREBY THE AERIAL EASEMENT TOTALS TWENTY ONE FEET, SIX INCHES (21' 6") IN WIDTH.

FURTHER, OWNERS HAVE DEDICATED AND BY THESE PRESENTS DO DEDICATE TO THE USE OF THE PUBLIC FOR PUBLIC UTILITY PURPOSE FOREVER UNOBSTRUCTED AERIAL EASEMENTS. THE AERIAL EASEMENTS SHALL EXTEND HORIZONTALLY AN ADDITIONAL TEN FEET (10' 0") FOR TEN FEET (10' 0") BACK-TO-BACK GROUND EASEMENTS, OR EIGHT FEET (8' 0") FOR FOURTEEN FEET (14' 0") BACK-TO-BACK GROUND EASEMENTS OR SEVEN FEET (7' 0") FOR SIXTEEN FEET (16' 0") BACK-TO-BACK GROUND EASEMENTS, FROM A PLANE SIXTEEN FEET (16' 0") ABOVE THE GROUND LEVEL UPWARD, LOCATED ADJACENT TO AND ADJOINING SAID PUBLIC UTILITY EASEMENTS THAT ARE DESIGNATED WITH AERIAL EASEMENTS (U.E. AND A.E.) AS INDICATED AND DEPICTED HEREON, WHEREBY THE AERIAL EASEMENT TOTALS THIRTY FEET (30' 0") IN WIDTH.

FURTHER, OWNERS DO HEREBY DECLARE THAT ALL PARCELS OF LAND DESIGNATED AS LOTS ON THIS PLAT ARE ORIGINALLY INTENDED FOR THE CONSTRUCTION OF SINGLE FAMILY RESIDENTIAL DWELLING UNITS THEREON AND SHALL BE RESTRICTED FOR SAME UNDER THE TERMS AND CONDITIONS OF SUCH RESTRICTIONS FILED SEPARATELY.

FURTHER, OWNERS DO HEREBY COVENANT AND AGREE THAT ALL OF THE PROPERTY WITHIN THE BOUNDARIES OF THIS PLAT IS HEREBY RESTRICTED TO PREVENT THE DRAINAGE OF ANY SEPTIC TANKS INTO ANY PUBLIC OR PRIVATE STREET, PERMANENT ACCESS EASEMENT, ROAD OR ALLEY OR ANY DRAINAGE DITCH, EITHER DIRECTLY OR INDIRECTLY.

FURTHER, OWNERS DO HEREBY DEDICATE TO THE PUBLIC A STRIP OF LAND FIFTEEN (15) FEET WIDE ON EACH SIDE OF THE CENTER LINE OF ANY AND ALL BAYOUS, CREEKS, GULLIES, RAVINES, DRAWS, SLOUGHS OR OTHER NATURAL DRAINAGE COURSES LOCATED IN SAID PLAT, AS EASEMENTS FOR DRAINAGE PURPOSES, GIVING THE CITY OF HOUSTON, HARRIS COUNTY, OR ANY OTHER GOVERNMENTAL AGENCY, THE RIGHT TO ENTER UPON SAID EASEMENT AT ANY AND ALL TIMES FOR THE PURPOSE OF CONSTRUCTION AND MAINTENANCE OF DRAINAGE FACILITIES AND STRUCTURES.

FURTHER, OWNERS DO HEREBY COVENANT AND AGREE THAT ALL OF THE PROPERTY WITHIN THE BOUNDARIES OF THIS PLAT AND ADJACENT TO ANY DRAINAGE EASEMENT, DITCH, GULLY, CREEK OR NATURAL DRAINAGE WAY SHALL HEREBY BE RESTRICTED TO KEEP SUCH DRAINAGE WAYS AND EASEMENTS CLEAR OF FENCES, BUILDINGS, PLANTING AND OTHER OBSTRUCTIONS TO THE OPERATIONS AND MAINTENANCE OF THE DRAINAGE FACILITY AND THAT SUCH ADJUTING PROPERTY SHALL NOT BE PERMITTED TO DRAIN DIRECTLY INTO THIS EASEMENT EXCEPT BY MEANS OF AN APPROVED DRAINAGE STRUCTURE.

FURTHER, OWNERS CERTIFY AND COVENANT THAT THEY HAVE COMPLIED WITH OR WILL COMPLY WITH EXISTING HARRIS COUNTY ROAD LAW, SECTION 31-C AS AMENDED BY CHAPTER 614, ACTS OF 1973, 63RD LEGISLATURE AND ALL OTHER REGULATIONS HERETOFORE ON FILE WITH THE HARRIS COUNTY ENGINEER AND ADOPTED BY THE COMMISSIONERS' COURT OF HARRIS COUNTY.

IN TESTIMONY WHEREOF, THE WOODLANDS LAND DEVELOPMENT COMPANY, L.P., A TEXAS LIMITED PARTNERSHIP HAS CAUSED THESE PRESENTS TO BE SIGNED BY ITS AUTHORIZED REPRESENTATIVE, TIM WELBES, THIS 3rd DAY OF September, 2013.

THE WOODLANDS LAND DEVELOPMENT COMPANY, L.P.
A TEXAS LIMITED PARTNERSHIP

BY: Tim Welbes
TIM WELBES, AUTHORIZED REPRESENTATIVE

STATE OF TEXAS
COUNTY OF MONTGOMERY

BEFORE ME, THE UNDERSIGNED AUTHORITY, ON THIS DAY PERSONALLY APPEARED TIM WELBES, AUTHORIZED REPRESENTATIVE OF THE WOODLANDS LAND DEVELOPMENT COMPANY, L.P., A TEXAS LIMITED PARTNERSHIP, KNOWN TO ME TO BE THE PERSON WHOSE NAME IS SUBSCRIBED TO THE FOREGOING INSTRUMENT AND ACKNOWLEDGED TO ME THAT HE EXECUTED THE SAME FOR THE PURPOSES AND CONSIDERATIONS THEREIN EXPRESSED AND IN THE CAPACITY THEREIN AND HEREIN STATED, AND AS THE ACT AND DEED OF SAID PARTNERSHIP.

GIVEN UNDER MY HAND AND SEAL OF OFFICE, THIS 13 DAY OF September, 2013.

NOTARY PUBLIC IN AND FOR THE STATE OF TEXAS
MY COMMISSION EXPIRES:

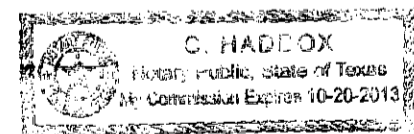

I, STEPHEN P. MATOVICH, A REGISTERED PROFESSIONAL LAND SURVEYOR, AM AUTHORIZED UNDER THE LAWS OF THE STATE OF TEXAS TO PRACTICE THE PROFESSION OF SURVEYING AND HEREBY CERTIFY THAT THE ABOVE SUBDIVISION IS TRUE AND CORRECT; WAS PREPARED FROM AN ACTUAL SURVEY OF THE PROPERTY MADE UNDER MY SUPERVISION ON THE GROUND; THAT ALL BOUNDARY CORNERS, ANGLE POINTS, POINTS OF CURVATURE AND OTHER POINTS OF REFERENCE HAVE BEEN MARKED WITH IRON (OR OTHER SUITABLE PERMANENT METAL) PIPES OR RODS HAVE AN OUTSIDE DIAMETER OF NOT LESS THAN THREE QUARTER (3/4) INCH AND A LENGTH OF NOT LESS THAN THREE (3) FEET (SEE NOTE 7) HAS BEEN TIED TO THE NEAREST STREET INTERSECTION AND THE TEXAS STATE PLANE COORDINATES (NAD83).

Stephen P. Matovich 2-7-13
STEPHEN P. MATOVICH, R.P.L.S.
TEXAS REGISTRATION NO. 5347



THIS IS TO CERTIFY THAT THE PLANNING COMMISSION OF THE CITY OF HOUSTON, TEXAS, HAS APPROVED THIS PLAT AND SUBDIVISION OF THE WOODLANDS CREEKSIDE PARK WEST SEC 20 IN CONFORMANCE WITH THE LAWS OF THE STATE OF TEXAS AND THE ORDINANCES OF THE CITY OF HOUSTON AS SHOWN HEREON AND AUTHORIZED THE RECORDING OF THIS PLAT THIS 11th DAY OF MARCH, 2013.

BY: Mark A. Kilkenny
MARK A. KILKENNY, CHAIR
OR M. SONNY GARZA, VICE CHAIR

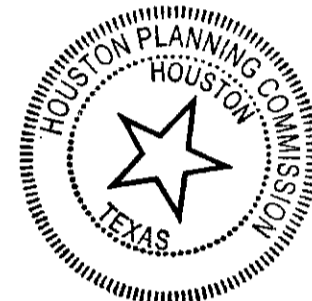

BY: Marlene L. Gafrick
MARLENE L. GAFRICK, SECRETARY

I, ARTHUR L. STOREY, JR., COUNTY ENGINEER OF HARRIS COUNTY, HEREBY CERTIFY THAT THE PLAT OF THIS SUBDIVISION COMPLIES WITH ALL THE EXISTING RULES AND REGULATIONS OF THIS OFFICE AS ADOPTED BY THE HARRIS COUNTY COMMISSIONERS' COURT AND THAT IT COMPLIES OR WILL COMPLY WITH ALL APPLICABLE PROVISIONS OF THE HARRIS COUNTY ROAD LAW AS AMENDED AND ALL OTHER COURT ADOPTED DRAINAGE REQUIREMENTS.

Arthur L. Storey Jr. 6-3-13
ARTHUR L. STOREY, JR., P.E.
COUNTY ENGINEER

I, STAN STANART, COUNTY CLERK OF HARRIS COUNTY AND EX OFFICIO CLERK OF THE HARRIS COUNTY COMMISSIONERS' COURT, DO HEREBY CERTIFY THAT THE WITHIN INSTRUMENT WAS APPROVED AT A LEGALLY CONVENED MEETING OF THE HARRIS COUNTY COMMISSIONERS' COURT HELD ON June 11, 2013 BY AN ORDER ENTERED INTO THE MINUTES OF THE COURT.

STAN STANART
COUNTY CLERK
OF HARRIS COUNTY, TEXAS

BY: Lita Marie Palomo
DEPUTY

I, STAN STANART, COUNTY CLERK OF HARRIS COUNTY, DO HEREBY CERTIFY THAT THE WITHIN INSTRUMENT WITH ITS CERTIFICATE OF AUTHENTICATION WAS FILED FOR REGISTRATION IN MY OFFICE ON June 13, 2013, AT 2:40 O'CLOCK P.M., AND DULY RECORDED ON June 13, 2013, AT 11:11 O'CLOCK A.M., AND AT FILM CODE NO. 655014 OF THE MAP RECORDS OF HARRIS COUNTY FOR SAID COUNTY.

WITNESS MY HAND AND SEAL OF OFFICE, AT HOUSTON, THE DAY AND DATE LAST ABOVE WRITTEN.

STAN STANART
COUNTY CLERK
OF HARRIS COUNTY, TEXAS

BY: Edwina V. Mack
DEPUTY EDWINA V. MACK



This certificate is valid only as to the instrument on which the original signature is affixed and only then to the extent that such instrument is not altered or changed after recording.

ANY PROVISION HEREIN WHICH RESTRICTS THE SALE, RENTAL OR USE OF THE DESCRIBED REAL PROPERTY BECAUSE OF COLOR OR RACE IS INVALID AND UNENFORCEABLE UNDER FEDERAL LAW.

ANY PROVISION HEREIN WHICH RESTRICTS THE SALE, RENTAL OR USE OF THE DESCRIBED REAL PROPERTY BECAUSE OF COLOR OR RACE IS INVALID AND UNENFORCEABLE UNDER FEDERAL LAW.

ANY PROVISION HEREIN WHICH RESTRICTS THE SALE, RENTAL OR USE OF THE DESCRIBED REAL PROPERTY BECAUSE OF COLOR OR RACE IS INVALID AND UNENFORCEABLE UNDER FEDERAL LAW.

ANY PROVISION HEREIN WHICH RESTRICTS THE SALE, RENTAL OR USE OF THE DESCRIBED REAL PROPERTY BECAUSE OF COLOR OR RACE IS INVALID AND UNENFORCEABLE UNDER FEDERAL LAW.

ANY PROVISION HEREIN WHICH RESTRICTS THE SALE, RENTAL OR USE OF THE DESCRIBED REAL PROPERTY BECAUSE OF COLOR OR RACE IS INVALID AND UNENFORCEABLE UNDER FEDERAL LAW.

OFFICE OF
STAN STANART
COUNTY CLERK, HARRIS COUNTY, TEXAS
MAP RECORDS OF COUNTY CLERK

FILM CODE 655014

THE WOODLANDS CREEKSIDE PARK
WEST SEC 20

THIS IS PAGE 1 OF 3 PAGES

SCANNER KM-4850W
KEY MAP

THE WOODLANDS CREEKSIDE PARK WEST SEC 20

A SUBDIVISION OF 24.137 ACRES OF LAND SITUATED
IN THE GEORGE GALBRAITH SURVEY, ABSTRACT 22,
HARRIS COUNTY, TEXAS.

43 LOTS 4 RESERVES (9.997 ACRES) 2 BLOCKS
FEBRUARY 5, 2013 JOB NO. 0472-8020P-310

OWNERS:
THE WOODLANDS LAND DEVELOPMENT COMPANY, L.P.

TIM WELBES, AUTHORIZED REPRESENTATIVE
24 WATERWAY AVE., STE. 1100, THE WOODLANDS, TEXAS 77380
PH. (281) 719-6100

ENGINEER:
LJA Engineering Inc.
2929 Briarpark Drive Suite 600 Houston, Texas 77042
Phone 713.953.5200 Fax 713.953.5026

UNOFFICIAL COPY

OFFICE OF
STAN STANART
COUNTY CLERK, HARRIS COUNTY, TEXAS
MAP RECORDS OF COUNTY CLERK

FILM CODE 855015
THE WOODLANDS CREEKSIDE PARK WEST SEC 20
THIS IS PAGE 2 OF 3 PAGES
SCANNER KM-4850w
KEY MAP

NOTES:

- UNLESS OTHERWISE INDICATED, THE BUILDING LINES (B.L.), WHETHER ONE OR MORE, SHOWN ON THIS SUBDIVISION PLAN ARE ESTABLISHED TO EVIDENCE COMPLIANCE WITH THE APPLICABLE PROVISIONS OF CHAPTER 42, CODE OF ORDINANCES, CITY OF HOUSTON, TEXAS, IN EFFECT AT THE TIME THIS PLAN WAS APPROVED, WHICH MAY BE AMENDED FROM TIME TO TIME.
- ALL BEARINGS ARE REFERENCED TO THE 1927 TEXAS STATE PLANE COORDINATE SYSTEM, LAMBERT PROJECTION, SOUTH CENTRAL ZONE.
- THE COORDINATES SHOWN HEREON ARE TEXAS SOUTH CENTRAL ZONE NO. 4204 STATE PLANE GRID COORDINATES (NAD83) AND MAY BE BROUGHT TO SURFACE BY APPLYING THE FOLLOWING COMBINED SCALE 0.999982773.
- SINGLE FAMILY RESIDENTIAL SHALL MEAN THE USE OF A LOT WITH ONE BUILDING DESIGNED FOR AND CONTAINING NOT MORE THAN TWO SEPARATE UNITS WITH FACILITIES FOR LIVING, SLEEPING, COOKING AND EATING THEREIN. A LOT UPON WHICH IS LOCATED A FREE-STANDING BUILDING CONTAINING ONE DWELLING UNIT AND A DETACHED SECONDARY DWELLING UNIT OF NOT MORE THAN 900 SQUARE FEET ALSO SHALL BE CONSIDERED SINGLE-FAMILY RESIDENTIAL. A BUILDING THAT CONTAINS ONE DWELLING UNIT ON ONE LOT THAT IS CONNECTED BY A PARTY WALL TO ANOTHER BUILDING CONTAINING ONE DWELLING UNIT ON AN ADJACENT LOT SHALL BE SINGLE-FAMILY RESIDENTIAL.
- EACH LOT SHALL PROVIDE A MINIMUM OF TWO OFF-STREET PARKING SPACES PER DWELLING UNIT ON EACH LOT. IN THOSE INSTANCES WHERE A SECONDARY UNIT IS PROVIDED ONLY ONE ADDITIONAL SPACE SHALL BE PROVIDED.
- ALL SPLIT UTILITY EASEMENTS EXTEND EQUAL DISTANCE EITHER SIDE OF PROPERTY LINES UNLESS OTHERWISE SHOWN.
- THREE FOURTHS (3/4) INCH IRON RODS THREE FEET (3') IN LENGTH WILL BE SET ON ALL PERIMETER BOUNDARY CORNERS, UNLESS OTHERWISE NOTED.
- THIS PLAN REQUIRES COMPLIANCE WITH LANDSCAPING REQUIREMENTS PRIOR TO OCCUPANCY OF STRUCTURES AS MANDATED IN "REGULATIONS OF HARRIS COUNTY, TEXAS FOR THE APPROVAL AND ACCEPTANCE OF INFRASTRUCTURE".
- LOTS ADJACENT TO RESTRICTED RESERVES RESTRICTED TO OPEN SPACE ARE DENIED DIRECT DRIVEWAY ACCESS ACROSS SAID RESERVES.
- ONE-FOOT RESERVE DEDICATED TO THE PUBLIC IN FEE AS A BUFFER SEPARATION BETWEEN THE SIDE OR END OF STREETS IN SUBDIVISION PLANS WHERE SUCH STREETS ADJACENT ACREAGE TRACTS, THE CONDITIONS OF SUCH DEDICATION BEING THAT WHEN THE ADJACENT PROPERTY IS SUBDIVIDED IN A RECORDED PLAN, THE ONE-FOOT RESERVE SHALL THEREUPON BECOME VESTED IN THE PUBLIC FOR STREET RIGHT-OF-WAY PURPOSES AND THE FEE THERETO SHALL REVERT AND REVEST IN THE DEDICATOR, HIS HEIRS, ASSIGNS, OR SUCCESSORS.
- THE FOLLOWING RESTRICTIONS SHALL PERTAIN TO ANY DRAINAGE EASEMENT CONTAINED WITHIN THE BOUNDARIES OF THIS PLAN:
 - PROHIBITS ALL PROPERTIES ABUTTING THE EASEMENT FROM THE CONSTRUCTION OF FENCES OR BUILDINGS, WHETHER TEMPORARY OR PERMANENT, AND THE INSTALLATION OR MAINTENANCE OF PLANTING OR OTHER OBSTRUCTIONS TO THE OPERATION AND MAINTENANCE OF THE DRAINAGE FACILITY WITHIN THE DRAINAGE EASEMENT.
 - PROHIBITS ANY PROPERTY ABUTTING THE DRAINAGE EASEMENT FROM DRAINAGE DIRECTLY INTO THE DRAINAGE EASEMENT EXCEPT BY MEANS OF A DRAINAGE STRUCTURE APPROVED BY THE DIRECTOR OF PUBLIC WORKS AND ENGINEERING OR THE AUTHORIZED PUBLIC DRAINAGE OR FLOOD CONTROL OFFICIAL.
- ALL LOTS WITHIN THIS SUBDIVISION ARE:
 - RESTRICTED TO A 20 FOOT CARPORT OR GARAGE SETBACK WHEN THE FACE IS PARALLEL TO THE STREET. THE REMAINDER OF THE STRUCTURE SHALL BE RESTRICTED TO A 20' FOOT BUILDING LINE (SEE DIAGRAM "A").
 - RESTRICTED TO A 10 FOOT FRONT BUILDING LINE WHEN THE FACE OF ANY CARPORT OR GARAGE IS PERPENDICULAR TO THE STREET (SEE DIAGRAM "B").
- HOUSTON LIGHTING & POWER COMPANY EASEMENT 10 FEET WIDE TOGETHER WITH AN AERIAL EASEMENT 10 FEET WIDE FROM A PLANE 16 FEET ABOVE THE GROUND UPWARD AS RECORDED UNDER CLERK'S FILE NO. P736702 OF THE REAL PROPERTY RECORDS OF HARRIS COUNTY, TEXAS.
- WATERLINE EASEMENT AS RECORDED UNDER CLERK'S FILE NO. 20120309010 OF THE REAL PROPERTY RECORDS OF HARRIS COUNTY, TEXAS IS NOT SHOWN BECAUSE IT IS LOCATED IN THE RIGHT-OF-WAY OF GARRETT RIDGE DRIVE.
- HARRIS COUNTY ROADWAY EASEMENT AS RECORDED UNDER CLERK'S FILE NO. 20120313452 OF THE REAL PROPERTY RECORDS OF HARRIS COUNTY, TEXAS IS NOT SHOWN BECAUSE IT IS LOCATED IN THE RIGHT-OF-WAY OF GARRETT RIDGE DRIVE.

RESERVE	TYPE	ACREAGE	SQ.FT.
"A"	RESTRICTED TO OPEN SPACE	2.339	101,875
"B"	RESTRICTED TO OPEN SPACE	0.062	2,716
"C"	RESTRICTED TO OPEN SPACE	0.057	2,467
"D"	RESTRICTED TO DRAINAGE	7.539	328,403
TOTAL		9.997	435,461

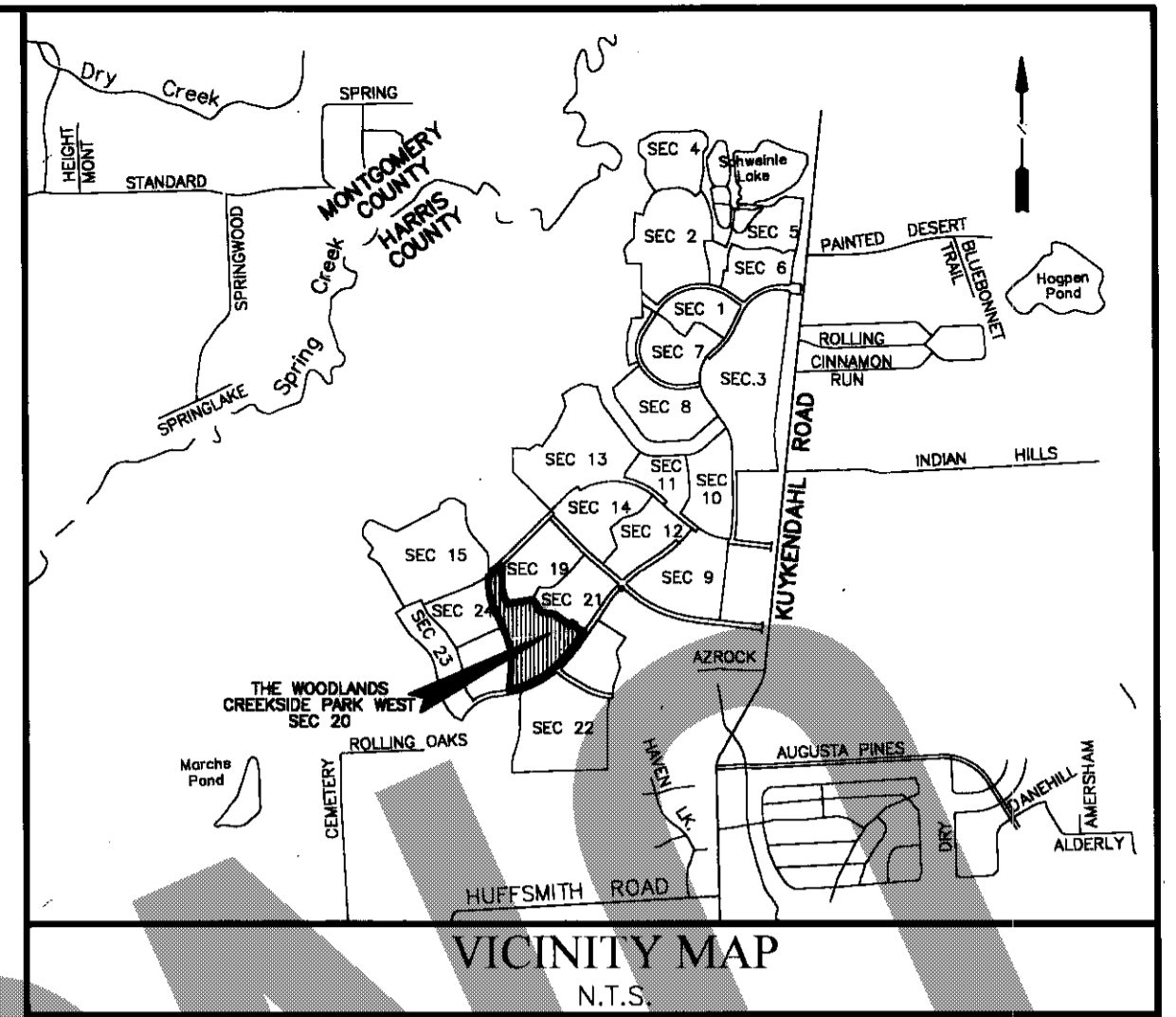
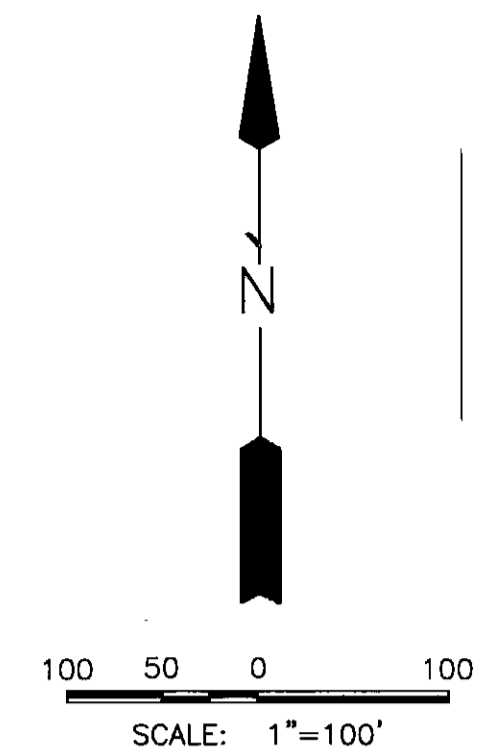

LINE	BEARING	DISTANCE
L1	N 68-42-09 E	30.00
L2	S 36-56-51 E	81.88
L3	S 29-28-41 E	20.35
L4	S 28-21-37 E	68.27
L5	S 34-46-13 E	48.54
L6	N 34-38-54 E	50.00
L7	S 55-21-06 E	90.00
L8	S 36-23-10 W	137.20
L9	S 19-36-46 W	54.10
L10	S 63-06-48 W	57.58
L11	N 55-21-06 W	145.41
L12	N 07-08-07 W	81.91
L13	N 88-42-08 E	122.05
L14	N 58-21-08 W	114.00
L15	S 34-38-54 W	90.24
L16	S 36-23-10 W	137.20
L17	S 19-36-46 W	12.68
L18	N 19-36-46 E	12.22
L19	N 55-21-06 W	133.93
L20	N 07-08-07 W	9.00
L21	S 07-08-07 E	9.00
L22	S 21-17-52 E	35.27
L23	N 68-42-08 E	72.05
L24	S 36-23-10 W	137.20
L25	S 55-21-06 E	145.41
L26	S 21-17-52 E	57.87
L27	S 68-42-08 W	72.05
L28	N 36-27-29 E	74.78
L29	N 41-04-09 E	109.25
L30	N 44-02-07 E	61.59
L31	N 47-03-50 E	92.25
L32	N 50-02-37 E	98.85
L33	N 53-27-18 E	70.48
L34	N 56-09-02 E	66.25
L35	N 59-40-41 E	66.35
L36	S 03-11-04 E	70.38
L37	S 13-07-25 E	114.52
L38	S 13-47-47 E	96.55
L39	S 17-20-15 E	65.16
L40	S 55-21-06 E	20.00
L41	S 55-21-06 E	114.00
L42	N 34-38-54 E	155.00
L43	N 21-17-52 W	193.14
L44	N 00-13-36 E	73.38
L45	S 21-17-52 E	50.24
L46	S 34-38-54 W	129.48
L47	S 59-57-55 E	54.28
L48	S 59-57-55 E	15.31

CURVE	RADIUS	TANGENT	CHORD	ARC	DELTA	CHORD BEARING
C1	1465.08	585.08	1302.88	1130.50	44-12-49	N 56-45-18 E
C2	1090.00	297.48	501.16	505.88	28-34-53	N 08-00-26 W
C3	25.00	25.00	35.36	39.27	90-00-00	S 10-21-06 E
C4	25.00	25.00	35.36	39.27	90-00-00	N 79-38-54 E
C5	2000.00	30.33	60.66	60.66	1-44-16	S 35-31-02 W
C6	100.00	97.01	139.26	154.03	88-15-44	N 80-31-02 W
C7	200.00	79.79	148.23	151.85	43-30-02	S 41-21-47 W
C8	250.00	78.58	146.41	148.59	34-03-14	N 38-19-29 W
C9	200.00	24.84	49.31	48.44	14-09-45	N 14-12-59 W
C10	240.00	127.47	225.15	234.35	55-56-46	S 83-19-29 E
C11	25.00	25.00	35.36	39.27	90-00-00	N 10-21-06 W
C12	25.00	25.00	35.36	39.27	90-00-00	S 79-38-54 W
C13	2025.00	30.71	61.42	61.42	1-44-16	S 35-31-02 W
C14	125.00	63.38	113.02	117.38	53-45-20	S 63-15-50 W
C15	25.00	17.68	28.87	30.77	70-31-44	S 54-52-50 W
C16	225.00	79.09	149.23	152.11	38-44-03	S 38-58-47 W
C17	100.00	26.38	51.02	51.59	29-33-35	S 43-34-01 W
C18	50.00	77.28	83.98	214.50	245-45-11	N 28-18-29 W
C19	100.00	44.04	80.81	82.97	47-32-09	N 70-49-24 E
C20	175.00	42.73	83.02	83.82	33-20-03 E	S 33-20-03 E
C21	25.00	16.17	30.43	32.71	74-57-52	N 17-52-10 W
C22	275.00	84.22	161.05	163.45	34-03-14	N 38-19-29 W
C23	225.00	27.95	55.47	55.62	14-09-45	N 14-12-59 W
C24	100.00	30.15	57.74	58.57	33-33-26	N 23-54-50 W
C25	50.00	75.38	83.33	215.65	247-06-53	N 82-51-53 E
C26	100.00	30.15	57.74	58.57	33-33-26	S 09-38-36 W
C27	175.00	16.17	30.43	32.71	14-09-45	S 14-12-59 E
C28	25.00	25.00	35.36	39.27	90-00-00	S 66-17-52 E
C29	285.00	140.74	248.60	208.76	55-56-46	S 83-19-29 E
C30	25.00	25.00	35.36	39.27	90-00-00	N 79-38-54 E
C31	25.00	25.45	35.67	39.72	91-01-17	N 09-50-28 W
C32	1975.00	12.35	24.70	24.70	0-42-59	N 36-01-40 E
C33	75.00	72.76	104.45	115.53	88-15-44	N 80-31-02 E
C34	225.00	68.91	131.77	133.73	34-03-14	S 38-19-29 E
C35	25.00	25.00	35.36	39.27	90-00-00	S 23-42-08 W
C36	215.00	114.19	201.89	208.64	55-56-46	N 83-19-29 W
C37	50.00	10.34	20.67	20.21	23-09-28	N 44-54-29 W
C38	50.00	13.03	25.22	25.49	29-12-35	S 13-48-31 E
C39	50.00	15.72	30.00	30.47	34-54-55	S 15-28-34 W
C40	840.00	216.80	418.49	423.97	29-50-08	N 09-10-33 W
C41	900.00	190.17	372.12	374.82	23-51-43	N 11-42-16 W
C42	1235.00	128.70	258.02	258.48	11-53-58	N 51-36-12 E
C43	780.00	151.01	298.51	298.32	21-54-50	S 10-20-27 E

P.O.B. (NAD 27)
X= 3,087,573.9255
Y= 855,480.2252

LEGEND

- B.L. INDICATES BUILDING LINE
- U.E. INDICATES UTILITY EASEMENT
- D.E. INDICATES DRAINAGE EASEMENT
- W.L.E. INDICATES WATER LINE EASEMENT
- S.S.E. INDICATES SANITARY SEWER EASEMENT
- STM.S.E. INDICATES STORM SEWER EASEMENT
- H.C.D.R. INDICATES HARRIS COUNTY DEED RECORDS
- H.C.O.P.R.R.P. INDICATES HARRIS COUNTY OFFICIAL PUBLIC RECORDS OF REAL PROPERTY
- O.P.R.R.P.H.C. INDICATES OFFICIAL PUBLIC RECORDS OF REAL PROPERTY HARRIS COUNTY
- H.C.M.R. INDICATES HARRIS COUNTY MAP RECORDS
- R.O.W. INDICATES RIGHT-OF-WAY
- U.V.E. INDICATES UNOBSTRUCTED VISIBILITY EASEMENT
- F.C. NO. INDICATES FILM CODE NUMBER
- INDICATES STREET NAME CHANGE
- SET INDICATES SET 3/4" IRON ROD
- FND INDICATES FOUND 3/4" IRON ROD

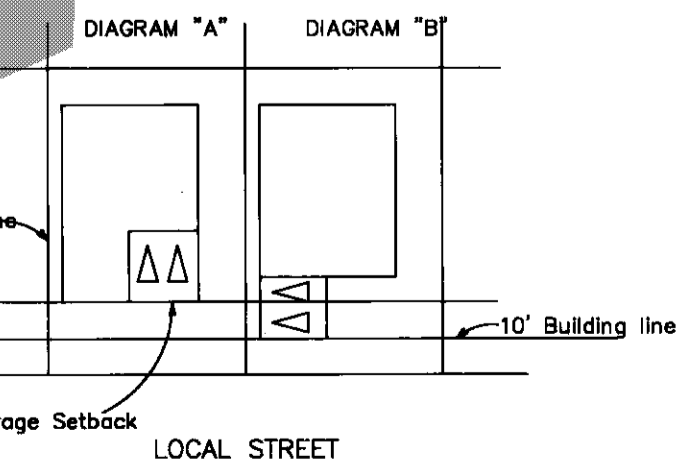

RECORDERS MEMORANDUM
At the time of recording, this instrument was found to be in compliance with the best photographic reproduction practices of legibility, color and photo copy, discolored paper, etc. All blackouts, additions and changes were present at the time the instrument was filed and recorded.

THE WOODLANDS CREEKSIDE PARK WEST SEC 20

A SUBDIVISION OF 24.137 ACRES OF LAND SITUATED IN THE GEORGE GALBRAITH SURVEY, ABSTRACT 22, HARRIS COUNTY, TEXAS.

43 LOTS 4 RESERVES (9.997 ACRES) 2 BLOCKS
FEBRUARY 18, 2013 JOB NO. 0472-8020P-310

OWNERS:
THE WOODLANDS LAND DEVELOPMENT COMPANY, L.P.

TIM WELBES, AUTHORIZED REPRESENTATIVE
24 WATERWAY AVE., STE. 1100, THE WOODLANDS, TEXAS 77380
PH. (281) 719-6100

ENGINEER:
LJA Engineering Inc.
2929 Briarpark Drive Phone 713.953.5200
Suite 600 Houston, Texas 77042 Fax 713.953.5026



MIKE SULLIVAN
HARRIS COUNTY TAX ASSESSOR-COLLECTOR
1001 PRESTON AVE., SUITE 100
HOUSTON, TEXAS 77002

Issued To: WOODLANDS LAND DEVELOPMENT COMPANY LP
Legal Description: TR 21 ABST 22 G GALBRAITH

Account Number: 040-222-000-0075
Certificate No: 11968055
Certificate Fee: \$10.00

Parcel Address: 0 HUFSMITH RD
Legal Acres: 50.0000
Print Date: 02/12/2013
Issue Date: 02/12/2013
Operator ID: DPURSLEY

TAX CERTIFICATES ARE ISSUED WITH THE MOST CURRENT INFORMATION AVAILABLE. ALL ACCOUNTS ARE SUBJECT TO CHANGE PER SECTION 26.15 OF THE TEXAS PROPERTY TAX CODE.

Exemptions: TIMBER
Certified Owner: WOODLANDS LAND DEVELOPMENT COMPANY LP

Table with columns: 2012 Value, 2012 Levy, 2012 Levy Balance, Prior Year Levy Balance, Total Levy Due, P&I + Attorney Fee, Total Amount Due. Values range from \$0.00 to \$536.71.

DUO TO ITS ASSIGNED USAGE, THE ABOVE LEGAL PROPERTY MAY HAVE RECEIVED SPECIAL VALUATION, AND ADDITIONAL ROLLBACK TAXES MAY BECOME DUE BASED ON THE PROVISIONS OF THE SPECIAL VALUATION

Reference (GF) No: N/A
Issued By: Mike Sullivan
HARRIS COUNTY TAX ASSESSOR-COLLECTOR

delinquent_tax_certificate.pdf v1.72

AD NUMBER: 040222000075
GF NUMBER:
CERTIFICATE NO: 1724594
COLLECTING AGENCY: Brian Ludwig

DATE: 2/11/2013
FEE: \$10.00
PROPERTY DESCRIPTION: TR 21 ABST 22 G GALBRAITH

REQUESTED BY: COURTHOUSE SPECIALISTS
9800 NW FRWY #400
HOUSTON TX 77092

PROPERTY OWNER: WOODLANDS LAND DEVELOPMENT COMPANY LP
9800 NW FRWY #400
SPRING TX 773875050

THIS IS TO CERTIFY THAT THE AD VALOREM RECORDS OF THE TOMBALL ISD TAX ASSESSOR-COLLECTOR REFLECT THE TAX, INTEREST, AND OTHER STATUTORY FEES THAT HAVE BEEN ASSESSED AND ARE NOW DUE TO THE TAXING ENTITIES AND FOR THE YEARS SET OUT BELOW FOR THE DESCRIBED PROPERTY HEREIN.

Table with columns: LAND MKT VALUE, AG LAND VALUE, APPRAISED VALUE, IMPROVEMENT, DEF HOMESTEAD, LIMITED VALUE. Values range from 60,000 to 130,000.

Table with columns: YEAR, TAX UNIT, LEVY, PEN, INT, DEF INT, ATTY, AMOUNT DUE. Values range from 0.00 to 0.00.

TOTAL CERTIFIED TAX DUE 2/2013: \$ 0.00

ISSUED TO: COURTHOUSE SPECIALISTS
ACCOUNT NUMBER: 040222000075

CERTIFIED BY: [Signature] TOMBALL I.S.D.

This is a statement from the Tax Collector of Tomball I.S.D., indicating that the taxes to be imposed by Tomball Independent School District for the 2013 tax year have not been calculated as of the above date.

AD NUMBER: 040222000029
GF NUMBER:
CERTIFICATE NO: 1724588
COLLECTING AGENCY: Brian Ludwig

J.R. MOORE, JR.
MONTGOMERY COUNTY TAX ASSESSOR/ COLLECTOR
400 N. SAN JACINTO
CONROE, TX 77391-2823

Issued To: COURTHOUSE DIRECT COM INC
Legal Description: TR 6F ABST 22 G GALBRAITH

Account Number: 00.0402.22.0000029
Certificate No: 216156267
Certificate Fee: \$10.00

Parcel Address: 9014 HUFSMITH RD
Legal Acres: 15.0000
Print Date: 02/08/2013
Paid Date: 02/08/2013
Issue Date: 02/08/2013
Operator ID: KKELLEY

TAX CERTIFICATES ARE ISSUED WITH THE MOST CURRENT INFORMATION AVAILABLE. ALL ACCOUNTS ARE SUBJECT TO CHANGE PER SECTION 26.15 OF THE TEXAS PROPERTY TAX CODE.

Exemptions:
Certified Owner: THE WOODLANDS LAND DEVELOPMENT CO LP
313 THE WOODLANDS TOWNSHIP

Table with columns: 2012 Value, 2012 Levy, 2012 Levy Balance, Prior Year Levy Balance, Total Levy Due, P&I + Attorney Fee, Total Amount Due. Values range from \$0.00 to \$518.31.

TOTAL CERTIFIED TAX DUE 2/2013: \$ 0.00
ISSUED TO: COURTHOUSE SPECIALISTS
ACCOUNT NUMBER: 040222000029

CERTIFIED BY: [Signature] TOMBALL I.S.D.

Reference (GF) No: N/A
Issued By: J.R. MOORE, JR.
MONTGOMERY COUNTY TAX ASSESSOR/ COLLECTOR

This is a statement from the Tax Collector of Tomball I.S.D., indicating that the taxes to be imposed by Tomball Independent School District for the 2013 tax year have not been calculated as of the above date.

delinquent_tax_certificate.pdf v1.72

OFFICE OF STAN STANART
COUNTY CLERK, HARRIS COUNTY, TEXAS
MAP RECORDS OF COUNTY CLERK
655016
FILM CODE

THE WOODLANDS CREEKSIDE PARK
WEST SEC 20

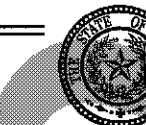

J.R. MOORE, JR.
MONTGOMERY COUNTY TAX ASSESSOR/ COLLECTOR
400 N. SAN JACINTO
CONROE, TX 77391-2823

Issued To: WOODLANDS LAND DEVELOPMENT COMPANY LP
Legal Description: TR 21 ABST 22 G GALBRAITH

Account Number: 00.0402.22.0000075
Certificate No: 216156263
Certificate Fee: \$20.00

Parcel Address: 0 HUFSMITH RD
Legal Acres: 50.0000
Print Date: 02/08/2013
Paid Date: 02/08/2013
Issue Date: 02/08/2013
Operator ID: KKELLEY

TAX CERTIFICATES ARE ISSUED WITH THE MOST CURRENT INFORMATION AVAILABLE. ALL ACCOUNTS ARE SUBJECT TO CHANGE PER SECTION 26.15 OF THE TEXAS PROPERTY TAX CODE.

Exemptions: TIMBER LAND
Certified Owner: WOODLANDS LAND DEVELOPMENT COMPANY LP

Table with columns: 2012 Value, 2012 Levy, 2012 Levy Balance, Prior Year Levy Balance, Total Levy Due, P&I + Attorney Fee, Total Amount Due. Values range from \$0.00 to \$216.56.

PROPERTY OMITTED FROM THE APPRAISAL ROLL AS DESCRIBED UNDER TAX ROLL SECTION 25.21 IS NOT INCLUDED IN THE CERTIFICATE (TAX ROLL SECTION 31.06(B)).

Reference (GF) No: N/A
Issued By: J.R. MOORE, JR.
MONTGOMERY COUNTY TAX ASSESSOR/ COLLECTOR

delinquent_tax_certificate.pdf v1.72



MIKE SULLIVAN
HARRIS COUNTY TAX ASSESSOR-COLLECTOR
1001 PRESTON AVE., SUITE 100
HOUSTON, TEXAS 77002

Issued To: WOODLANDS LAND DEVELOPMENT COMPANY LP
Legal Description: TR 4 ABST 22 G GALBRAITH

Account Number: 040-222-000-0015
Certificate No: 11968057
Certificate Fee: \$10.00

Parcel Address: 0 HUFSMITH RD
Legal Acres: 50.0000
Print Date: 02/12/2013
Paid Date: 02/12/2013
Issue Date: 02/12/2013
Operator ID: DPURSLEY

TAX CERTIFICATES ARE ISSUED WITH THE MOST CURRENT INFORMATION AVAILABLE. ALL ACCOUNTS ARE SUBJECT TO CHANGE PER SECTION 26.15 OF THE TEXAS PROPERTY TAX CODE.

Exemptions:
Certified Owner: WOODLANDS LAND DEVELOPMENT COMPANY LP

Table with columns: 2012 Value, 2012 Levy, 2012 Levy Balance, Prior Year Levy Balance, Total Levy Due, P&I + Attorney Fee, Total Amount Due. Values range from \$0.00 to \$3,425.54.

TOTAL CERTIFIED TAX DUE 2/2013: \$ 0.00
ISSUED TO: COURTHOUSE SPECIALISTS
ACCOUNT NUMBER: 040222000015

CERTIFIED BY: [Signature] TOMBALL I.S.D.

Reference (GF) No: N/A
Issued By: Mike Sullivan
HARRIS COUNTY TAX ASSESSOR-COLLECTOR



MIKE SULLIVAN
HARRIS COUNTY TAX ASSESSOR-COLLECTOR
1001 PRESTON AVE., SUITE 100
HOUSTON, TEXAS 77002

Issued To: THE WOODLANDS LAND DEVELOPMENT CO LP
Legal Description: TR 6F ABST 22 G GALBRAITH

Account Number: 040-222-000-0029
Certificate No: 11968058
Certificate Fee: \$10.00

Parcel Address: 9014 HUFSMITH RD
Legal Acres: 15.0000
Print Date: 02/12/2013
Paid Date: 02/12/2013
Issue Date: 02/12/2013
Operator ID: DPURSLEY

TAX CERTIFICATES ARE ISSUED WITH THE MOST CURRENT INFORMATION AVAILABLE. ALL ACCOUNTS ARE SUBJECT TO CHANGE PER SECTION 26.15 OF THE TEXAS PROPERTY TAX CODE.

Exemptions:
Certified Owner: THE WOODLANDS LAND DEVELOPMENT CO LP

Table with columns: 2012 Value, 2012 Levy, 2012 Levy Balance, Prior Year Levy Balance, Total Levy Due, P&I + Attorney Fee, Total Amount Due. Values range from \$0.00 to \$1,284.59.

Reference (GF) No: N/A
Issued By: Mike Sullivan
HARRIS COUNTY TAX ASSESSOR-COLLECTOR

delinquent_tax_certificate.pdf v1.72

AD NUMBER: 040222000015
GF NUMBER:
CERTIFICATE NO: 1724601
COLLECTING AGENCY: Brian Ludwig

DATE: 2/11/2013
FEE: \$10.00
PROPERTY DESCRIPTION: TR 4 ABST 22 G GALBRAITH

Issued To: WOODLANDS LAND DEVELOPMENT COMPANY LP
Legal Description: TR 4 ABST 22 G GALBRAITH

Account Number: 00.0402.22.0000015
Certificate No: 216156267
Certificate Fee: \$10.00

Parcel Address: 9014 HUFSMITH RD
Legal Acres: 15.0000
Print Date: 02/08/2013
Paid Date: 02/08/2013
Issue Date: 02/08/2013
Operator ID: KKELLEY

TAX CERTIFICATES ARE ISSUED WITH THE MOST CURRENT INFORMATION AVAILABLE. ALL ACCOUNTS ARE SUBJECT TO CHANGE PER SECTION 26.15 OF THE TEXAS PROPERTY TAX CODE.

Exemptions:
Certified Owner: THE WOODLANDS LAND DEVELOPMENT CO LP
313 THE WOODLANDS TOWNSHIP

Table with columns: 2012 Value, 2012 Levy, 2012 Levy Balance, Prior Year Levy Balance, Total Levy Due, P&I + Attorney Fee, Total Amount Due. Values range from \$0.00 to \$518.31.

TOTAL CERTIFIED TAX DUE 2/2013: \$ 0.00
ISSUED TO: COURTHOUSE SPECIALISTS
ACCOUNT NUMBER: 040222000015

CERTIFIED BY: [Signature] TOMBALL I.S.D.

This is a statement from the Tax Collector of Tomball I.S.D., indicating that the taxes to be imposed by Tomball Independent School District for the 2013 tax year have not been calculated as of the above date.

delinquent_tax_certificate.pdf v1.72

TAX CERTIFICATE



J.R. MOORE, JR.
MONTGOMERY COUNTY TAX ASSESSOR/ COLLECTOR
400 N. SAN JACINTO
CONROE, TX 77301-2823

Issued To:
COURTHOUSE DIRECT.COM INC
9800 NORTHWEST FRWY STE 400
HOUSTON, TX 77092

Legal Description:
TR 4
ABST 22 G GALBRAITH

Fiduciary Number: 22409577

Parcel Address: 0 HUFSMITH RD
Legal Acres: 50.0000

Account Number: 00.0402.22.0000015
Certificate No: 216156265
Certificate Fee: \$30.00

Print Date: 02/08/2013
Paid Date: 02/08/2013
Issue Date: 02/08/2013
Operator ID: KKELLEY

TAX CERTIFICATES ARE ISSUED WITH THE MOST CURRENT INFORMATION AVAILABLE. ALL ACCOUNTS ARE SUBJECT TO CHANGE PER SECTION 26.15 OF THE TEXAS PROPERTY TAX CODE. THIS IS TO CERTIFY THAT ALL TAXES DUE ON THE ABOVE DESCRIBED PROPERTY HAVE BEEN EXAMINED, UP TO AND INCLUDING THE YEAR 2012. ALL TAXES ARE PAID IN FULL.

Exemptions:

Certified Owner:

WOODLANDS LAND DEVELOPMENT
COMPANY LP
PO BOX 5050
SPRING, TX 77387-5050

Certified Tax Unit(s):

313 THE WOODLANDS TOWNSHIP

2012 Value: 435,600
2012 Levy: \$1,382.16
2012 Levy Balance: \$0.00
Prior Year Levy Balance: \$0.00
Total Levy Due: \$0.00
P&I + Attorney Fee: \$0.00
Total Amount Due: \$0.00

PROPERTY OMITTED FROM THE APPRAISAL ROLL AS DESCRIBED UNDER TAX ROLL SECTION 25.21 IS NOT INCLUDED IN THE CERTIFICATE [TAX ROLL SECTION 31.08(B)]. DUE TO ITS ASSIGNED USAGE, THE ABOVE LEGAL PROPERTY MAY HAVE RECEIVED SPECIAL VALUATION, AND ADDITIONAL ROLLBACK TAXES MAY BECOME DUE BASED ON THE PROVISIONS OF THE SPECIAL VALUATION

Reference (GF) No: N/A

Issued By:
J.R. MOORE, JR.
MONTGOMERY COUNTY TAX ASSESSOR/ COLLECTOR
(936) 539-7897

delinquent_tax_certificate.pdf v1.72

TAX CERTIFICATE



MIKE SULLIVAN
HARRIS COUNTY TAX ASSESSOR-COLLECTOR
1001 PRESTON AVE, SUITE 100
HOUSTON, TEXAS 77002

Issued To:

WOODLANDS LAND DEVELOPMENT
COMPANY LP
PO BOX 5050
SPRING, TX 77387-5050

Legal Description:

TR5 7 7A 7B 7C 7D 8 10 14 14A
& 22
ABST 22 G GALBRAITH

Parcel Address: 26435 KUYKENDAHLL RD
Legal Acres: 49.8988

Account Number: 040-222-000-0032

Certificate No: 11968032
Certificate Fee: \$10.00

Print Date: 02/12/2013
Paid Date: 02/12/2013
Issue Date: 02/12/2013
Operator ID: DPUKRSLEY

TAX CERTIFICATES ARE ISSUED WITH THE MOST CURRENT INFORMATION AVAILABLE. ALL ACCOUNTS ARE SUBJECT TO CHANGE PER SECTION 26.15 OF THE TEXAS PROPERTY TAX CODE. THIS IS TO CERTIFY THAT ALL TAXES DUE ON THE ABOVE DESCRIBED PROPERTY HAVE BEEN EXAMINED, UP TO AND INCLUDING THE YEAR 2012. ALL TAXES ARE PAID IN FULL.

Exemptions:

Certified Owner:

WOODLANDS LAND DEVELOPMENT
COMPANY LP
PO BOX 5050
SPRING, TX 77387-5050

Certified Tax Unit(s):

40 Harris County
41 Harris County Flood Control Dist
42 Part of Houston Authority
43 Harris County Hospital District
44 Harris County Dept. of Education
45 Lone Star College System
666 Emergency Service Dist #11 (E.M.S.)

2012 Value: 478,190
2012 Levy: \$3,760.46
2012 Levy Balance: \$0.00
Prior Year Levy Balance: \$0.00
Total Levy Due: \$0.00
P&I + Attorney Fee: \$0.00
Total Amount Due: \$0.00

Reference (GF) No: N/A

Issued By:
MIKE SULLIVAN
HARRIS COUNTY TAX ASSESSOR-COLLECTOR

delinquent_tax_certificate.pdf v1.72

TAX CERTIFICATE FOR ACCOUNT: 0402220000032
AD NUMBER: 0402220000032
GF NUMBER:
CERTIFICATE NO: 1724607
COLLECTING AGENCY:
Eliam Ludwig
PO Box 276
Tomball TX 77377-0276

DATE: 2/11/2013
FEE: \$10.00
PROPERTY DESCRIPTION:
TRS 7 7A 7B 7C 7D 8 10 14 14A
& 22
ABST 22 G GALBRAITH
0026435 KUYKENDAHLL RD
49.8988 ACRES

PAGE 1 OF 1

REQUESTED BY:
COURTHOUSE SPECIALISTS
9800 NW FRWY #400
HOUSTON TX 77092

PROPERTY OWNER:
WOODLANDS LAND DEVELOPMENT
COMPANY LP
PO BOX 5050
SPRING TX 773875050

THIS IS TO CERTIFY THAT THE AD VALOREM RECORDS OF THE TOMBALL ISD TAX ASSESSOR-COLLECTOR REFLECT THE TAX, INTEREST, AND OTHER STATUTORY FEES THAT HAVE BEEN ASSESSED AND ARE NOW DUE TO THE TAXING ENTITIES AND FOR THE YEARS SET OUT BELOW FOR THE DESCRIBED PROPERTY HEREIN. THE TAX ASSESSOR-COLLECTOR MAKES NO CERTIFICATION AS TO THE AMOUNT OF TAX, PENALTY, INTEREST, OR OTHER FEES ASSESSED BY OR DUE ANY TAXING ENTITY FOR THE YEAR OR YEARS FOR WHICH THE TAX ASSESSOR-COLLECTOR DID NOT HAVE THE STATUTORY DUTY TO COLLECT OR KEEP RECORDS OF SUCH COLLECTION. ADDITIONAL TAXES MAY BECOME DUE ON THE DESCRIBED PROPERTY, WHICH ARE NOT REFLECTED HEREIN, IF THE SAID DESCRIBED PROPERTY HAS OR IS RECEIVING ANY SPECIAL STATUTORY VALUATIONS THAT MAY TRIGGER TAX ROLLBACK PROVISIONS. THIS CERTIFICATE APPLIES TO ADVALOREM TAXES ONLY AND DOES NOT APPLY TO ANY SPECIAL ASSESSMENT LEVIES.

Table with columns: CURRENT VALUES, LAND MKT VALUE, AG LAND VALUE, APPRAISED VALUE, EXEMPTIONS, IMPROVEMENT, DEF HOMESTEAD, LIMITED VALUE.

Table with columns: YEAR, TAX UNIT, LEVY, PEN, INT, DEF INT, ATTY, AMOUNT DUE. Includes 2012 TOMBALL I.S.D. row.

TOTAL CERTIFIED TAX DUE 2/2013: \$ 0.00

ISSUED TO: COURTHOUSE SPECIALISTS
ACCOUNT NUMBER: 0402220000032

CERTIFIED BY: *[Signature]* TOMBALL I.S.D.

This is a statement from the Tax Collector of Tomball I.S.D., indicating that the taxes to be imposed by Tomball Independent School District for the 2013 tax year have not been calculated as of the above date.

TAX CERTIFICATE

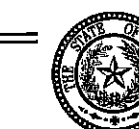

J.R. MOORE, JR.
MONTGOMERY COUNTY TAX ASSESSOR/ COLLECTOR
400 N. SAN JACINTO
CONROE, TX 77301-2823

Issued To:
COURTHOUSE DIRECT.COM INC
9800 NORTHWEST FRWY STE 400
HOUSTON, TX 77092

Legal Description:
TR5 7 7A 7B 7C 7D 8 10 14 14A
& 22
ABST 22 G GALBRAITH

Fiduciary Number: 22409577

Parcel Address: 26435 KUYKENDAHLL RD
Legal Acres: 49.8988

Account Number: 00.0402.22.0000032
Certificate No: 216156258
Certificate Fee: \$20.00

Print Date: 02/08/2013
Paid Date: 02/08/2013
Issue Date: 02/08/2013
Operator ID: KKELLEY

TAX CERTIFICATES ARE ISSUED WITH THE MOST CURRENT INFORMATION AVAILABLE. ALL ACCOUNTS ARE SUBJECT TO CHANGE PER SECTION 26.15 OF THE TEXAS PROPERTY TAX CODE. THIS IS TO CERTIFY THAT ALL TAXES DUE ON THE ABOVE DESCRIBED PROPERTY HAVE BEEN EXAMINED, UP TO AND INCLUDING THE YEAR 2012. ALL TAXES ARE PAID IN FULL.

Exemptions:

Certified Owner:

WOODLANDS LAND DEVELOPMENT
COMPANY LP
PO BOX 5050
SPRING, TX 77387-5050

Certified Tax Unit(s):

313 THE WOODLANDS TOWNSHIP

2012 Value: 478,190
2012 Levy: \$1,517.30
2012 Levy Balance: \$0.00
Prior Year Levy Balance: \$0.00
Total Levy Due: \$0.00
P&I + Attorney Fee: \$0.00
Total Amount Due: \$0.00

PROPERTY OMITTED FROM THE APPRAISAL ROLL AS DESCRIBED UNDER TAX ROLL SECTION 25.21 IS NOT INCLUDED IN THE CERTIFICATE [TAX ROLL SECTION 31.08(B)]. DUE TO ITS ASSIGNED USAGE, THE ABOVE LEGAL PROPERTY MAY HAVE RECEIVED SPECIAL VALUATION, AND ADDITIONAL ROLLBACK TAXES MAY BECOME DUE BASED ON THE PROVISIONS OF THE SPECIAL VALUATION

Reference (GF) No: N/A

Issued By:
J.R. MOORE, JR.
MONTGOMERY COUNTY TAX ASSESSOR/ COLLECTOR
(936) 539-7897

delinquent_tax_certificate.pdf v1.72

Harris-Montgomery Counties Municipal Utility District Number 386

822 West Pasadena Boulevard
Deer Park, Texas 77536-5749
Phone: 281/479-7798 Fax: 281/479-5980

The Woodlands Land Development Company LP
PO Box 5050
Spring, TX 77387-5050

RE: Account Number: 040-222-000-0015
Account Number: 040-222-000-0029
Account Number: 040-222-000-0032
Account Number: 040-222-000-0075

Gentlemen,

You inquired about the 2012 property tax due on the above referenced accounts. These accounts are not within the jurisdictional boundaries of Harris-Montgomery Counties Municipal Utility District Number 386 and therefore no taxes are due.

Please do not hesitate to give us a call if you should have any questions regarding this matter.

Sincerely yours,

[Signature]
Tim Spencer
Tax Assessor-Collector
February 8, 2013

OFFICE OF
STAN STANART
COUNTY CLERK, HARRIS COUNTY, TEXAS

MAP RECORDS OF COUNTY CLERK

FILM CODE 855016A

THE WOODLANDS CREEKSIDE PARK
WEST SEC 20

THIS IS PAGE 3 OF 3 PAGES

SCANNER KM-4850w