

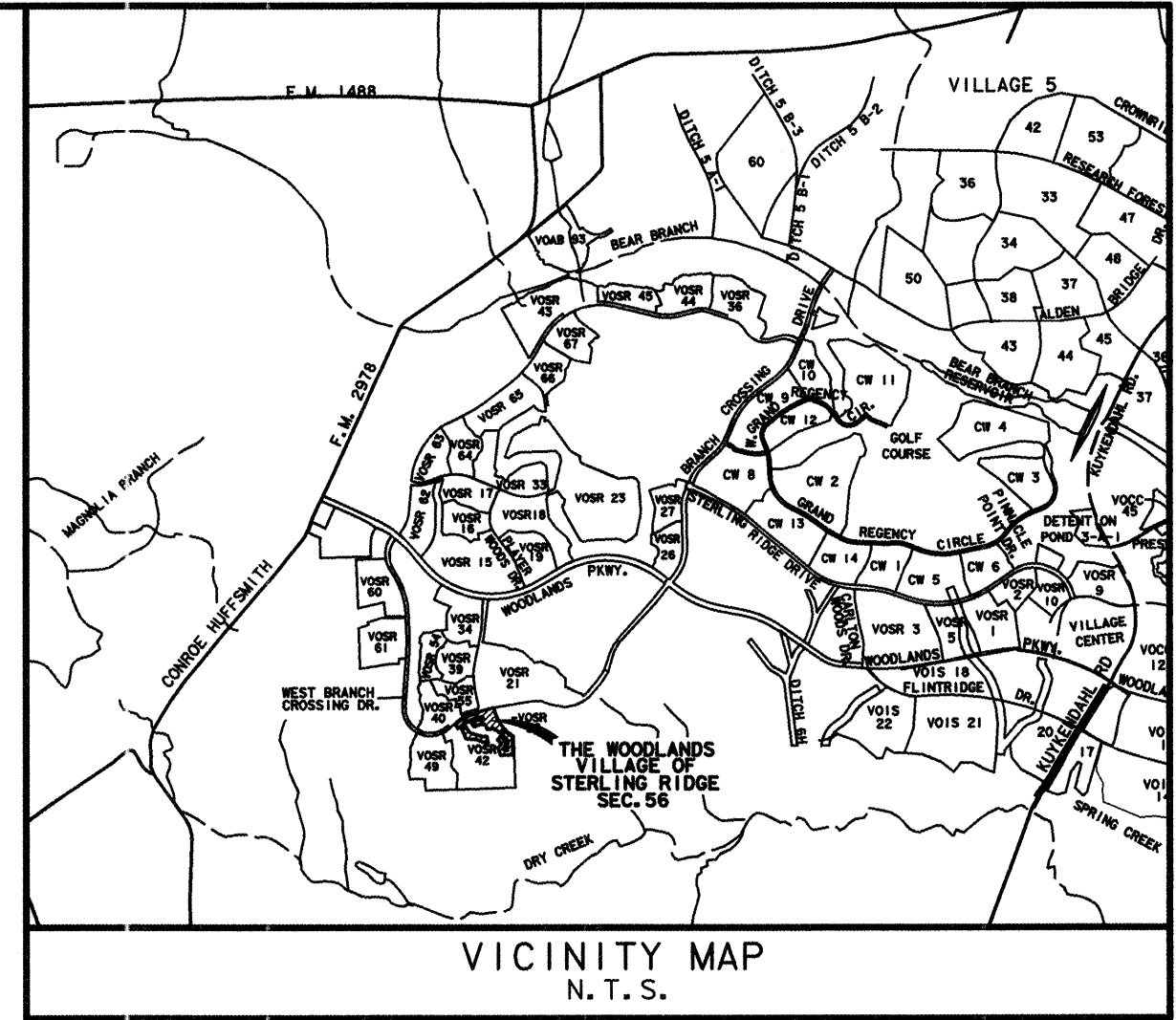

SCALE: 1" = 300'

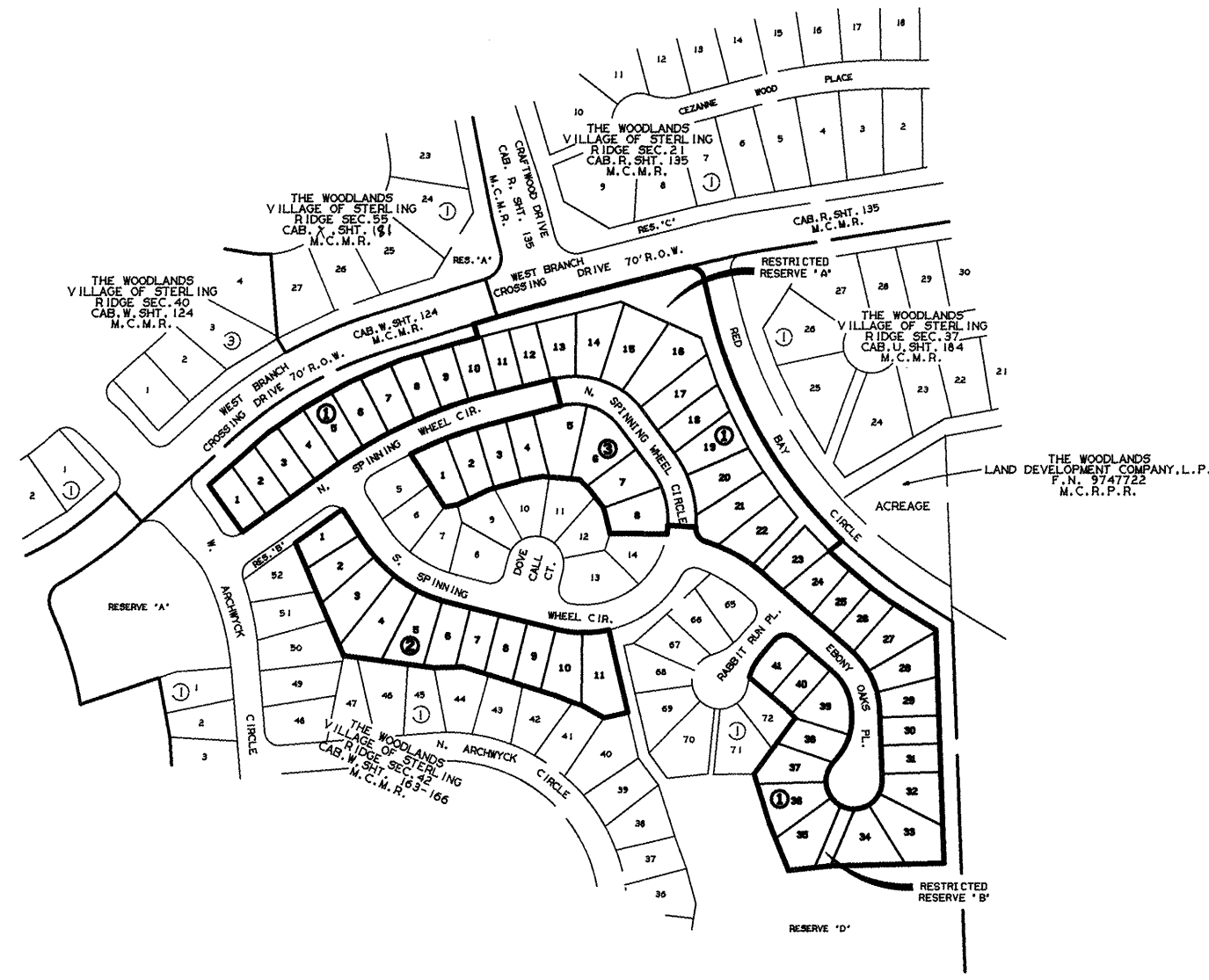

# THE WOODLANDS VILLAGE OF STERLING RIDGE SEC. 56

BEING 10.72 ACRES OUT OF THE JAMES BROWN SURVEY,  
ABSTRACT 78, AND ALSO BEING A PARTIAL REPLAT OF  
THE WOODLANDS VILLAGE OF STERLING RIDGE, SEC. 42,  
RECORDED IN CABINET "W", SHEETS 163 THROUGH 166  
OF THE MONTGOMERY COUNTY MAP RECORDS

REASON FOR REPLAT: TO ADJUST LOT LINES OF LOTS 53-64  
AND LOTS 73-90, BLOCK 1; LOTS 1-4, BLOCK 3; AND LOTS 1-11, BLOCK 4

OWNER: THE WOODLANDS LAND DEVELOPMENT COMPANY, L.P.  
2201 TIMBERLOCH PLACE  
THE WOODLANDS, TEXAS 77380

3 BLOCKS  
60 LOTS  
2 RESERVES  
0.87 ACRES IN RESERVE

ENGINEER: **LJA Engineering & Surveying, Inc.**  
2929 Briarpark Drive  
Suite 600  
Houston, Texas 77042-3703  
Phone 713.953.5200  
Fax 713.953.5026

DATE: FEBRUARY 16, 2005

*Jul # 2005-024318*      *Cub-X*      *Sheet 192*

3:\dsk1\0472\FINAL\PLA\FV05R56\*42.dgn  
2-23-2005 9:04:31

2005 MAR -9 AM 11:55

Mark Turnbull  
COUNTY CLERK  
MONTGOMERY COUNTY TEXAS

STATE OF TEXAS  
COUNTY OF MONTGOMERY

THE WOODLANDS LAND DEVELOPMENT COMPANY, L.P., ACTING HEREIN BY AND THROUGH THE WOODLANDS OPERATING COMPANY, L.P., ITS AUTHORIZED AGENT, ACTING HEREIN BY AND THROUGH ITS PRESIDENT AND CEO, THOMAS J. D'ALESSANDRO, IV, OWNER (HEREINAFTER REFERRED TO AS OWNER) OF THE PROPERTY SUBDIVIDED IN THE ABOVE AND FOREGOING MAP OF THE WOODLANDS, VILLAGE OF STERLING RIDGE, SEC. 56, DO HEREBY MAKE SUBDIVISION OF SAID PROPERTY FOR AND ON BEHALF OF SAID THE WOODLANDS LAND DEVELOPMENT COMPANY, L.P., ACCORDING TO THE LINES, STREETS, LOTS, ALLEYS, PARKS, BUILDING LINES AND EASEMENTS THEREON SHOWN AND DESIGNATE SAID SUBDIVISION AS THE WOODLANDS, VILLAGE OF STERLING RIDGE, SEC. 56, LOCATED IN THE JAMES BROWN SURVEY, ABSTRACT 78, MONTGOMERY COUNTY, TEXAS AND ON BEHALF OF SAID THE WOODLANDS LAND DEVELOPMENT COMPANY, L.P., AND DEDICATE TO PUBLIC USE, AS SUCH, THE STREETS (EXCEPT THOSE STREETS DESIGNATED AS PRIVATE STREETS OR PERMANENT ACCESS EASEMENTS), ALLEYS, PARKS AND EASEMENTS SHOWN THEREON FOREVER, AND DO HEREBY WAIVE ANY CLAIMS FOR DAMAGES OCCASIONED BY THE ESTABLISHING OF GRADES AS APPROVED FOR THE STREETS AND ALLEYS DEDICATED, OR OCCASIONED BY THE ALTERATION OF THE SURFACE OF ANY PORTION OF STREETS OR ALLEYS TO CONFORM TO SUCH GRADES, AND DO HEREBY BIND OURSELVES, OUR SUCCESSORS AND ASSIGNS TO WARRANT AND FOREVER DEFEND THE TITLE TO THE LAND SO DEDICATED.

THIS IS TO CERTIFY THAT THE WOODLANDS LAND DEVELOPMENT COMPANY, L.P., ACTING HEREIN BY AND THROUGH THE WOODLANDS OPERATING COMPANY, L.P., ITS AUTHORIZED AGENT, ACTING HEREIN BY AND THROUGH ITS PRESIDENT AND CEO, THOMAS J. D'ALESSANDRO, IV, OWNER OF THE PROPERTY SUBDIVIDED IN THE ABOVE AND FOREGOING MAP OF THE WOODLANDS, VILLAGE OF STERLING RIDGE, SEC. 56, HAVE COMPLIED OR WILL COMPLY WITH ALL REGULATIONS HEREOF ON FILE WITH THE MONTGOMERY COUNTY ENGINEER AND ADOPTED BY THE COMMISSIONERS COURT OF MONTGOMERY COUNTY, TEXAS.

FURTHER, OWNER HAS DEDICATED AND BY THESE PRESENTS DOES DEDICATE TO THE USE OF THE PUBLIC FOR PUBLIC UTILITY PURPOSES FOREVER UNOBSTRUCTED AERIAL EASEMENTS. THE AERIAL EASEMENTS SHALL EXTEND HORIZONTALLY AN ADDITIONAL ELEVEN FEET SIX INCHES (11' 6") FOR TEN FEET (10' 0") PERIMETER GROUND EASEMENTS OR FIVE FEET, SIX INCHES (5' 6") FOR SIXTEEN FEET (16' 0") PERIMETER GROUND EASEMENTS FROM A PLANE SIXTEEN FEET (16' 0") ABOVE GROUND LEVEL UPWARD, LOCATED ADJACENT TO AND ADJOINING SAID PUBLIC UTILITY EASEMENTS THAT ARE DESIGNATED WITH AERIAL EASEMENTS (U.E. & A.E.) AS INDICATED AND DEPICTED HEREON, WHEREBY, THE AERIAL EASEMENT TOTALS TWENTY-ONE FEET, SIX INCHES (21' 6") IN WIDTH.

FURTHER, OWNER HAS DEDICATED AND BY THESE PRESENTS DOES DEDICATE TO THE USE OF THE PUBLIC FOR PUBLIC UTILITY PURPOSES FOREVER UNOBSTRUCTED AERIAL EASEMENTS. THE AERIAL EASEMENTS SHALL EXTEND HORIZONTALLY AN ADDITIONAL TEN FEET (10' 0") FOR TEN FEET (10' 0") BACK-TO-BACK GROUND EASEMENTS OR SEVEN FEET (7' 0") FOR SIXTEEN FEET (16' 0") BACK-TO-BACK GROUND EASEMENTS, FROM A PLANE SIXTEEN FEET (16' 0") ABOVE GROUND LEVEL UPWARD, LOCATED ADJACENT TO BOTH SIDES AND ADJOINING SAID PUBLIC UTILITY EASEMENTS THAT ARE DESIGNATED WITH AERIAL EASEMENTS (U.E. & A.E.) AS INDICATED AND DEPICTED HEREON, WHEREBY, THE AERIAL EASEMENT TOTALS THIRTY FEET (30' 0") IN WIDTH.

FURTHER, OWNERS DO HEREBY DEDICATE FOREVER TO THE PUBLIC A STRIP OF LAND A MINIMUM FIFTEEN FEET (15' 0") WIDE ON EACH SIDE OF THE CENTERLINE OF ANY AND ALL GULLIES, RAVINES, DRAWS, SLOUGHS, OR OTHER NATURAL DRAINAGE COURSES LOCATED IN THE SAID SUBDIVISION, AS EASEMENTS FOR DRAINAGE PURPOSES, GIVING MONTGOMERY COUNTY AND/OR ANY OTHER PUBIC AGENCY THE RIGHT TO ENTER UPON SAID EASEMENTS AT ANY AND ALL TIMES FOR THE PURPOSE OF CONSTRUCTING AND/OR MAINTAINING DRAINAGE WORK AND/OR STRUCTURES.

FURTHER, ALL OF THE PROPERTY SUBDIVIDED IN THE ABOVE AND FOREGOING MAP SHALL BE RESTRICTED IN ITS USE, WHICH RESTRICTIONS SHALL RUN WITH THE TITLE TO THE PROPERTY, AND SHALL BE ENFORCEABLE, AT THE OPTION OF MONTGOMERY COUNTY, BY MONTGOMERY COUNTY OR ANY CITIZEN THEREOF, BY INJUNCTION, AS FOLLOWS:

- 1. THAT DRAINAGE OF SEPTIC TANKS INTO ROAD, STREET, ALLEY, OR OTHER PUBLIC DITCHES, EITHER DIRECTLY OR INDIRECTLY, IS STRICTLY PROHIBITED.
- 2. DRAINAGE STRUCTURES UNDER PRIVATE DRIVEWAYS SHALL HAVE A NET DRAINAGE OPENING AREA OF SUFFICIENT SIZE TO PERMIT THE FREE FLOW OF WATER WITHOUT BACKWATER, AND SHALL BE A MINIMUM OF ONE AND THREE QUARTERS (1-3/4) SQUARE FEET (18" DIAMETER PIPE CULVERT)

FURTHER, OWNERS HEREBY CERTIFY THAT THIS REPLAT DOES NOT ATTEMPT TO ALTER, AMEND, OR REMOVE ANY COVENANTS OR RESTRICTIONS.

IN TESTIMONY WHEREOF, THE WOODLANDS OPERATING COMPANY, L.P., A TEXAS LIMITED PARTNERSHIP, ACTING IN ITS CAPACITY AS AUTHORIZED AGENT OF THE WOODLANDS LAND DEVELOPMENT COMPANY, L.P., A TEXAS LIMITED PARTNERSHIP, HAS CAUSED THESE PRESENTS TO BE SIGNED BY THOMAS J. D'ALESSANDRO, IV, ITS PRESIDENT AND CEO, THEREUNTO AUTHORIZED THIS THE

26<sup>th</sup> DAY OF January, 2005.

THE WOODLANDS LAND DEVELOPMENT COMPANY, L.P.  
A TEXAS LIMITED PARTNERSHIP

BY: THE WOODLANDS OPERATING COMPANY, L.P.  
A TEXAS LIMITED PARTNERSHIP  
ITS AUTHORIZED AGENT

THOMAS J. D'ALESSANDRO, IV  
PRESIDENT AND CEO

STATE OF TEXAS  
COUNTY OF MONTGOMERY

BEFORE ME, THE UNDERSIGNED AUTHORITY, ON THIS DAY PERSONALLY APPEARED THOMAS J. D'ALESSANDRO, IV, PRESIDENT AND CEO OF THE WOODLANDS OPERATING COMPANY, L.P., A TEXAS LIMITED PARTNERSHIP, AUTHORIZED AGENT OF THE WOODLANDS LAND DEVELOPMENT COMPANY, L.P., A TEXAS LIMITED PARTNERSHIP, KNOWN TO ME TO BE THE PERSON WHOSE NAME IS SUBSCRIBED TO THE FOREGOING INSTRUMENT AND ACKNOWLEDGED TO ME THAT HE EXECUTED THE SAME FOR THE PURPOSES AND CONSIDERATIONS THEREIN EXPRESSED, AND IN THE CAPACITY THEREIN AND HEREIN SET OUT AND AS AN ACT AND DEED OF SAID LIMITED PARTNERSHIP.

GIVEN UNDER MY HAND AND SEAL OF OFFICE, THIS 26 DAY OF January, 2005.

Patricia B. Millspaugh  
NOTARY PUBLIC IN AND FOR THE STATE OF TEXAS

MY COMMISSION EXPIRES: 4-30-05

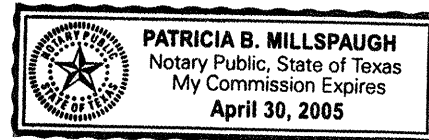

I, STEPHEN P. MATOVICH, AM REGISTERED UNDER THE LAWS OF THE STATE OF TEXAS TO PRACTICE THE PROFESSION OF SURVEYING AND HEREBY CERTIFY THAT THE ABOVE SUBDIVISION IS TRUE AND CORRECT; WAS PREPARED FROM AN ACTUAL SURVEY OF THE PROPERTY MADE UNDER MY SUPERVISION ON THE GROUND; THAT THE ELEVATION BENCHMARK REFLECTED ON THE FACE OF THE PLAT WAS ESTABLISHED AS REQUIRED BY REGULATION; THAT ALL CORNERS AND ANGLE POINTS OF THE BOUNDARIES OF THE ORIGINAL TRACT TO BE SUBDIVIDED OF REFERENCE HAVE BEEN MARKED WITH IRON RODS HAVING A DIAMETER OF NOT LESS THAN FIVE-EIGHTHS OF AN INCH (5/8") AND A LENGTH OF NOT LESS THAN THREE FEET (3'), AND THAT THE PLAT BOUNDARY CORNERS HAVE BEEN TIED TO THE NEAREST SURVEY CORNER.

Stephen P. Matovich 1-25-05  
STEPHEN P. MATOVICH  
TEXAS REGISTRATION NO. 5347



THIS IS TO CERTIFY THAT THE PLANNING COMMISSION OF THE CITY OF HOUSTON, TEXAS HAS APPROVED THIS PLAT AND SUBDIVISION OF THE WOODLANDS, VILLAGE OF STERLING RIDGE, SEC. 56 IN CONFORMANCE WITH THE LAWS OF THE STATE OF TEXAS AND THE ORDINANCES OF THE CITY OF HOUSTON AS SHOWN HEREON AND AUTHORIZED THE RECORDING OF THIS PLAT, THIS 29 DAY OF JAN, 2005.

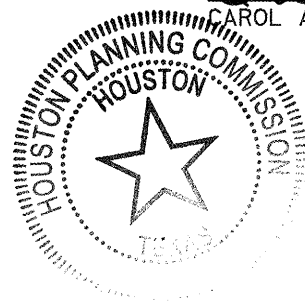

Carol A. Lewis  
CAROL A. LEWIS, CHAIRMAN

Robert M. Litke  
ROBERT M. LITKE,  
SECRETARY

I, MARK J. MOONEY, P.E., COUNTY ENGINEER OF MONTGOMERY COUNTY, TEXAS, DO HEREBY CERTIFY THAT THE PLAT OF THIS SUBDIVISION COMPLIES WITH ALL OF THE EXISTING RULES AND REGULATIONS OF THIS OFFICE AS ADOPTED BY THE MONTGOMERY COUNTY COMMISSIONERS' COURT.

I FURTHER CERTIFY THAT THE PLAT OF THIS SUBDIVISION COMPLIES WITH REQUIREMENTS FOR INTERNAL SUBDIVISION DRAINAGE AS ADOPTED BY THE MONTGOMERY COUNTY COMMISSIONERS' COURT; HOWEVER, NO CERTIFICATION IS HEREBY GIVEN AS TO THE EFFECT OF DRAINAGE FROM THIS SUBDIVISION TO THE INTERCEPTING DRAINAGE ARTERY OR PARENT STREAM OR ANY OTHER AREA OF SUBDIVISION WITHIN THE WATERSHED.

MARK J. MOONEY, P.E.  
MONTGOMERY COUNTY ENGINEER

APPROVED BY THE COMMISSIONERS' COURT OF MONTGOMERY COUNTY, TEXAS, THIS 7<sup>th</sup> DAY OF March, 2005.

Mike Meador  
MIKE MEADOR  
COMMISSIONER, PRECINCT 1

Craig Doyle  
CRAIG DOYLE  
COMMISSIONER, PRECINCT 2

ALAN B. SADLER  
COUNTY JUDGE

Ed Chance  
ED CHANCE  
COMMISSIONER, PRECINCT 3

Ed Rinehart  
ED RINEHART  
COMMISSIONER, PRECINCT 4

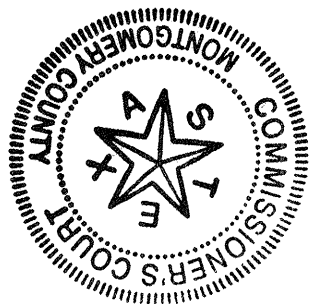

THE STATE OF TEXAS  
COUNTY OF MONTGOMERY

I, MARK TURNBULL, CLERK OF THE COUNTY COURT OF MONTGOMERY COUNTY, TEXAS, DO HEREBY CERTIFY THAT THE WITHIN INSTRUMENT WITH ITS CERTIFICATE OF AUTHENTICATION WAS FILED FOR REGISTRATION IN MY OFFICE ON 3-7-05 AT 9:30 O'CLOCK A.M., AND DULY RECORDED ON 3-9-2005, AT 11:55 O'CLOCK A.M., IN CABINET X, SHEETS 192-195 OF THE MAP RECORDS OF MONTGOMERY COUNTY.

WITNESS MY HAND AND SEAL OF OFFICE, AT CONROE, MONTGOMERY COUNTY, TEXAS THE DAY AND DATE LAST ABOVE WRITTEN.

Mark Turnbull  
MARK TURNBULL, CLERK OF THE COUNTY COURT  
MONTGOMERY COUNTY, TEXAS  
By: Alice Drake  
DEPUTY

OWNER: THE WOODLANDS LAND DEVELOPMENT COMPANY, L.P.  
2201 TIMBERLOCH PLACE  
THE WOODLANDS, TEXAS 77380

THE WOODLANDS  
VILLAGE OF  
STERLING RIDGE  
SEC. 56  
SHEET 2 OF 4

File #2005-024318

Tab. X Sheet 193

AVERY SMITH SURVEY A-499

ISSAC MANSFIELD SURVEY A-344  
A. SMITH SURVEY A-499

P.O.C.  
X= 3,083,005.0990  
Y= 869,779.9640

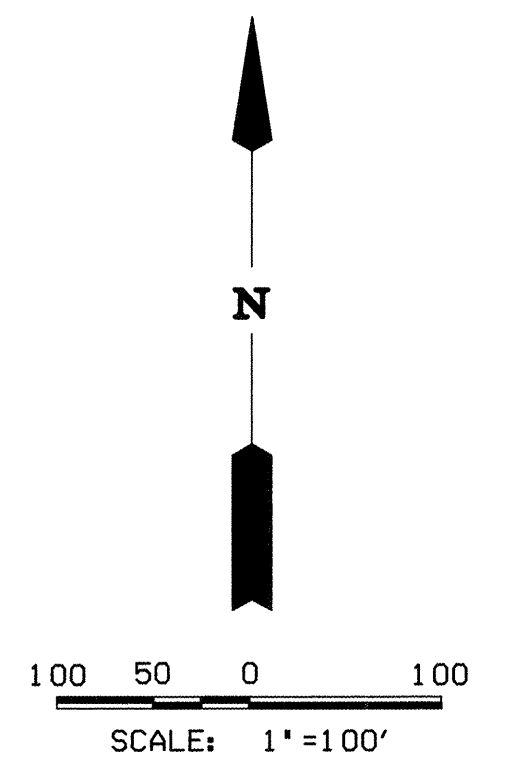

THE WOODLANDS VILLAGE OF STERLING RIDGE SEC. 55 CAB. X, SHT. 181 M.C.M.R.

THE WOODLANDS VILLAGE OF STERLING RIDGE SEC. 21 CAB. R, SHT. 135 M.C.M.R.

THE WOODLANDS VILLAGE OF STERLING RIDGE SEC. 40 CAB. W, SHT. 124 M.C.M.R.

CAB. R, SHT. 135 M.C.M.R.

THE WOODLANDS VILLAGE OF STERLING RIDGE SEC. 37 CAB. U, SHT. 184 M.C.M.R.

CRAFTWOOD DRIVE CAB. R, SHT. 135 M.C.M.R.

CAB. W, SHT. 124 M.C.M.R.

WEST BRANCH DRIVE 70' R.O.W. N-75-45-05-E 254.81

RESTRICTED RESERVE 'A' 0.83 AC. 36,245 SQ. FT. RESTRICTED TO OPEN SPACE

WEST BRANCH DRIVE 70' R.O.W. CROSSING

WHEEL CIR. N-75-44-58-E 222.94

THE WOODLANDS LAND DEVELOPMENT COMPANY, L.P. F.N. 9747722 M.C.R.P.R.

INDIAN HILLS SUBD IV. LOT 50 (UNRECORDED) ROLAND R. POWELL 6.049 ACRES F.N. 8022640, M.C.R.P.R.

THE WOODLANDS VILLAGE OF STERLING RIDGE SEC. 42 CAB. W, SHT. 163-166 M.C.M.R.

ACREAGE

RESERVE 'A'

N. SPINNING WHEEL CIR. N-75-58-42-E 199.70

INDIAN HILLS SUBD IV. LOT 43 (UNRECORDED) CHARLES W. ROBISON 6.153 ACRES F.N. 8538965 M.C.R.P.R.

THE WOODLANDS VILLAGE OF STERLING RIDGE SEC. 42 CAB. W, SHT. 163-166 M.C.M.R.

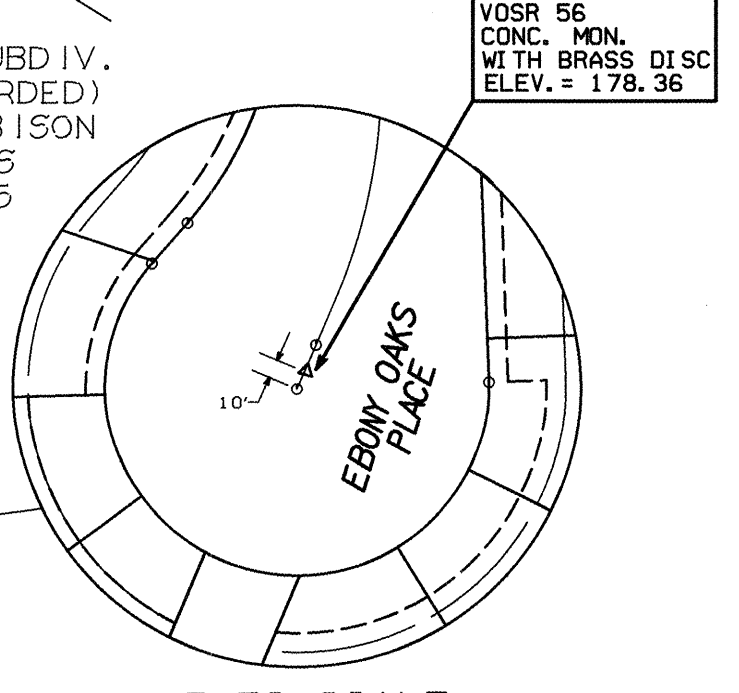

RESTRICTED RESERVE 'B' 0.07 AC. 2,864 SQ. FT. RESTRICTED TO OPEN SPACE

RESERVE 'D'

LEGEND

- B. L. INDICATES BUILDING LINE
- D. E. INDICATES DRAINAGE EASEMENT
- STM. S. E. INDICATES STORM SEWER EASEMENT
- S. S. E. INDICATES SANITARY SEWER EASEMENT
- W. L. E. INDICATES WATER LINE EASEMENT
- U. E. INDICATES UTILITY EASEMENT
- M. C. M. R. INDICATES MONTGOMERY COUNTY MAP RECORDS
- M. C. R. P. R. INDICATES MONTGOMERY COUNTY REAL PROPERTY RECORDS

File # 2005-024318 Cab. X Sheet 194

THE WOODLANDS VILLAGE OF STERLING RIDGE SEC. 56 SHEET 3 OF 4

3:\gsk\10472\FINAL\PLA\FVOSR56+42.dgn 2-23-2005 9:04:42

CURVE TABLE						
CURVE	RADIUS	TANGENT	CHORD	ARC	DELTA	CHORD BEARING
1	1765.00	46.63	93.22	93.23	03° 01' 35"	N-74-14-17-E
2	25.00	25.90	35.70	39.76	91° 07' 48"	S-58-41-01-E
3	825.00	244.99	469.72	476.30	33° 04' 44"	S-29-39-30-E
4	100.00	22.88	44.61	44.98	28° 46' 25"	N-28-07-04-E
5	25.00	25.00	35.38	39.27	90° 00' 00"	N-86-00-16-E
6	100.00	43.44	79.68	81.96	46° 57' 32"	S-26-30-58-E
7	100.00	39.43	73.37	75.12	43° 02' 28"	S-19-29-02-W
8	50.00	*	93.03	194.64	223° 02' 28"	S-70-30-58-E
9	150.00	65.16	119.53	122.94	46° 57' 32"	N-26-30-58-W
10	325.00	63.27	124.21	124.98	22° 01' 58"	N-60-00-43-W
11	25.00	19.07	30.32	32.58	74° 40' 12"	N-33-41-36-W
12	150.00	7.63	15.23	15.24	05° 49' 16"	S-06-33-08-W
13	780.00	79.09	157.37	157.64	11° 34' 46"	N-69-57-35-E
14	830.00	155.02	304.76	306.50	21° 09' 29"	S-65-10-14-W
15	150.00	99.95	166.35	176.33	67° 21' 08"	S-70-34-28-E
16	200.00	73.86	138.58	141.51	40° 32' 24"	S-16-37-42-E
17	150.00	55.40	103.93	106.13	40° 32' 24"	N-16-37-42-W
18	100.00	66.63	110.90	117.55	67° 21' 08"	N-70-34-28-W
19	325.00	10.06	20.10	20.11	03° 32' 42"	N-52-32-43-W
20	50.00	13.08	25.31	25.58	29° 19' 02"	S-76-05-31-E
21	125.00	83.29	138.62	146.94	67° 21' 08"	S-70-34-28-E
22	175.00	64.63	121.26	123.82	40° 32' 24"	S-16-37-42-E
23	25.00	3.14	6.23	6.25	14° 19' 05"	S-39-47-11-E
24	250.00	99.36	184.67	189.15	43° 21' 03"	S-54-18-10-E
25	200.00	47.82	93.01	93.87	26° 53' 29"	S-89-25-26-E

LINE TABLE		
LINE	BEARING	DISTANCE
1	N-35-24-31-W	102.45
2	N-55-55-58-E	73.48
3	N-60-06-49-E	95.28
4	N-66-38-35-E	103.59
5	N-73-01-32-E	98.22
6	N-75-17-50-E	42.57
7	N-19-04-34-W	25.32
8	N-72-43-30-E	43.72
9	S-13-07-07-E	60.31
10	N-50-48-10-W	30.22
11	S-46-53-08-E	27.90
12	S-50-12-55-E	71.05
13	S-53-51-59-E	39.05
14	S-58-13-38-E	83.38
15	S-59-49-12-E	13.54
16	S-83-53-00-W	75.03
17	N-21-49-21-W	93.48
18	N-16-43-00-W	90.61
19	N-42-35-55-W	24.83
20	N-48-59-44-W	85.53
21	N-41-00-16-E	36.52
22	S-48-59-44-E	88.90
23	S-02-02-12-E	12.50
24	S-41-00-15-W	14.11
25	N-86-21-30-W	50.00
26	N-89-32-57-W	100.81
27	N-14-12-05-W	46.82
28	N-37-49-41-W	36.97
29	N-44-38-08-W	28.86
30	N-85-33-43-W	66.47
31	S-79-39-10-W	29.49
32	S-74-38-56-W	68.68
33	S-64-40-15-W	61.40
34	S-80-34-45-W	23.07
35	N-32-37-39-W	111.07
36	N-14-15-02-W	50.00
37	S-36-53-54-E	92.12
38	N-86-21-30-W	50.00
39	N-36-53-54-W	92.12
40	N-55-55-58-E	18.80
41	N-66-38-35-E	21.92
42	N-66-38-35-E	23.29
43	N-75-44-58-E	16.88
44	N-73-01-32-E	6.41
45	N-75-45-01-E	5.68
46	N-75-44-58-E	6.06
47	S-65-36-03-E	6.52
48	S-22-23-53-E	5.99
49	S-22-23-53-E	20.03
50	S-29-30-39-E	22.02
51	S-32-23-27-E	2.97
52	S-32-23-27-E	15.18
53	N-35-12-12-W	51.04
54	S-38-22-17-E	11.23
55	S-46-53-08-E	27.90
56	S-50-12-55-E	21.04
57	S-58-13-38-E	11.24
58	S-01-57-37-E	3.90
59	S-02-02-12-E	13.60
60	S-02-02-12-E	11.59
61	N-41-00-16-E	0.82
62	N-16-43-00-W	19.30
63	N-41-00-16-E	13.29
64	N-02-02-12-W	12.50
65	N-48-59-44-W	3.90
66	N-42-35-55-W	10.22
67	N-42-35-55-W	14.61
68	N-80-34-45-E	23.07
69	N-64-40-15-E	23.24
70	N-74-38-56-E	10.47
71	N-75-44-58-E	21.79
72	N-74-38-56-E	8.57
73	N-79-39-10-E	29.49
74	S-85-33-43-E	12.97
75	S-85-33-43-E	15.01
76	S-44-38-08-E	17.80
77	S-44-38-08-E	11.26
78	N-43-51-40-W	62.36
79	S-43-17-48-W	112.95
80	N-38-22-17-W	50.03
81	N-35-29-31-W	24.67
82	N-32-23-27-W	49.72
83	N-29-30-39-W	22.02
84	N-27-15-56-W	72.94
85	N-24-34-01-W	52.13
86	N-18-59-33-W	88.91
87	S-22-49-39-W	110.73
88	S-83-53-00-W	28.57
89	S-36-53-54-E	92.12
90	S-77-07-49-W	43.75
91	N-59-25-16-W	46.30
92	N-73-02-41-W	16.26
93	N-67-53-15-W	31.83
94	S-88-07-18-W	51.52
95	N-54-35-29-E	101.99
96	S-32-37-39-E	61.12
97	S-32-37-39-E	12.32
98	S-23-10-15-E	19.11
99	S-82-18-44-E	19.35
100	N-88-07-18-E	13.42
101	S-75-58-42-E	1.04
102	S-72-34-03-E	29.19
103	S-73-02-41-E	16.26

GENERAL NOTES

- UNLESS OTHERWISE INDICATED, THE BUILDING LINES (B.L.), WHETHER ONE OR MORE, SHOWN ON THIS PLAT ARE ESTABLISHED TO EVIDENCE COMPLIANCE WITH THE APPLICABLE PROVISIONS OF CHAPTER 42, CODE OF ORDINANCES, CITY OF HOUSTON, TEXAS, IN EFFECT AT THE TIME THIS PLAT WAS APPROVED, WHICH MAY BE AMENDED FROM TIME TO TIME.
- SINGLE FAMILY RESIDENTIAL SHALL MEAN THE USE OF A LOT WITH ONE BUILDING DESIGNED FOR AND CONTAINING NOT MORE THAN TWO SEPARATE UNITS WITH FACILITIES FOR LIVING, SLEEPING, COOKING AND EATING THEREIN. A LOT UPON WHICH IS LOCATED A FREE-STANDING BUILDING CONTAINING ONE DWELLING UNIT AND A DETACHED SECONDARY DWELLING UNIT OF NOT MORE THAN 900 SQUARE FEET ALSO SHALL BE CONSIDERED SINGLE FAMILY RESIDENTIAL. A BUILDING THAT CONTAINS ONE DWELLING UNIT ON ONE LOT THAT IS CONNECTED BY A PARTY WALL TO ANOTHER BUILDING CONTAINING ONE DWELLING UNIT ON AN ADJACENT LOT SHALL BE SINGLE FAMILY RESIDENTIAL.
- EACH LOT SHALL PROVIDE A MINIMUM OF TWO OFF-STREET PARKING SPACES PER DWELLING UNIT ON EACH LOT. IN THOSE INSTANCES WHERE A SECONDARY UNIT IS PROVIDED, ONLY ONE ADDITIONAL SPACE SHALL BE PROVIDED.
- THE COORDINATES SHOWN HEREON ARE TEXAS CENTRAL ZONE NO. 4203 STATE PLAN GRID COORDINATES (NAD 83) AND MAY BE BROUGHT TO SURFACE BY APPLYING THE FOLLOWING COMBINED SCALE: 0.99997961
- ALL BEARINGS ARE REFERENCED TO THE 1927 TEXAS STATE PLANE COORDINATE SYSTEM, LAMBERT PROJECTION, SOUTH CENTRAL ZONE.
- ALL SPLIT UTILITY EASEMENTS EXTEND EQUAL DISTANCE EITHER SIDE OF PROPERTY LINES UNLESS OTHERWISE SHOWN.
- LOTS ADJACENT TO RESERVES RESTRICTED TO OPEN SPACE ARE DENIED DIRECT DRIVEWAY ACCESS ACROSS SAID RESERVES.
- THE FOLLOWING RESTRICTIONS SHALL PERTAIN TO ANY DRAINAGE EASEMENT CONTAINED WITHIN THE BOUNDARIES OF THIS PLAT:
  - PROHIBITS ALL PROPERTIES ABUTTING THE EASEMENT FROM THE CONSTRUCTION OF FENCES OR BUILDINGS, WHETHER TEMPORARY OR PERMANENT, AND THE INSTALLATION OR MAINTENANCE OF PLANTING OR OTHER OBSTRUCTIONS TO THE OPERATION AND MAINTENANCE OF THE DRAINAGE FACILITY WITHIN THE DRAINAGE EASEMENT.
  - PROHIBITS ANY PROPERTY ABUTTING THE DRAINAGE EASEMENT FROM DRAINAGE DIRECTLY INTO THE DRAINAGE EASEMENT EXCEPT BY MEANS OF A DRAINAGE STRUCTURE APPROVED BY THE DIRECTOR OF PUBLIC WORKS AND ENGINEERING OR THE AUTHORIZED PUBLIC DRAINAGE OR FLOOD CONTROL OFFICIAL.

RESERVES			
RESERVE	ACREAGE	SQ. FT.	TYPE
A	0.83	36,245	RESTRICTED TO OPEN SPACE
B	0.07	2,864	RESTRICTED TO OPEN SPACE
TOTAL	0.90	39,109	-----

OWNER: THE WOODLANDS LAND DEVELOPMENT COMPANY, L.P.  
 2201 TIMBERLOCH PLACE  
 THE WOODLANDS, TEXAS 77380

THE WOODLANDS  
 VILLAGE OF  
 STERLING RIDGE  
 SEC. 56  
 SHEET 4 OF 4

*File # 2005-024318*      *Cub-X*      *Sheet 195*