

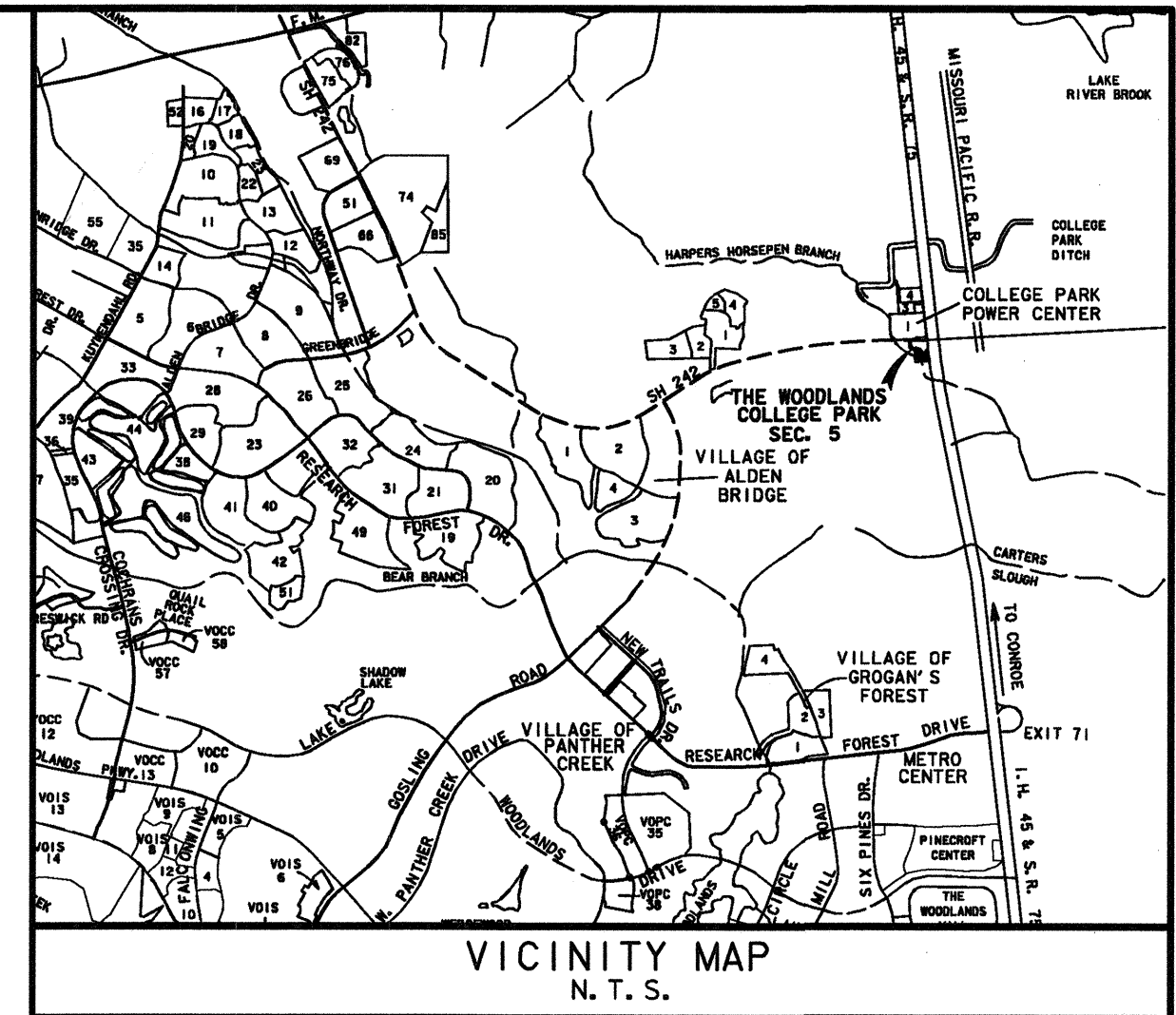

SCALE: 1" = 300'

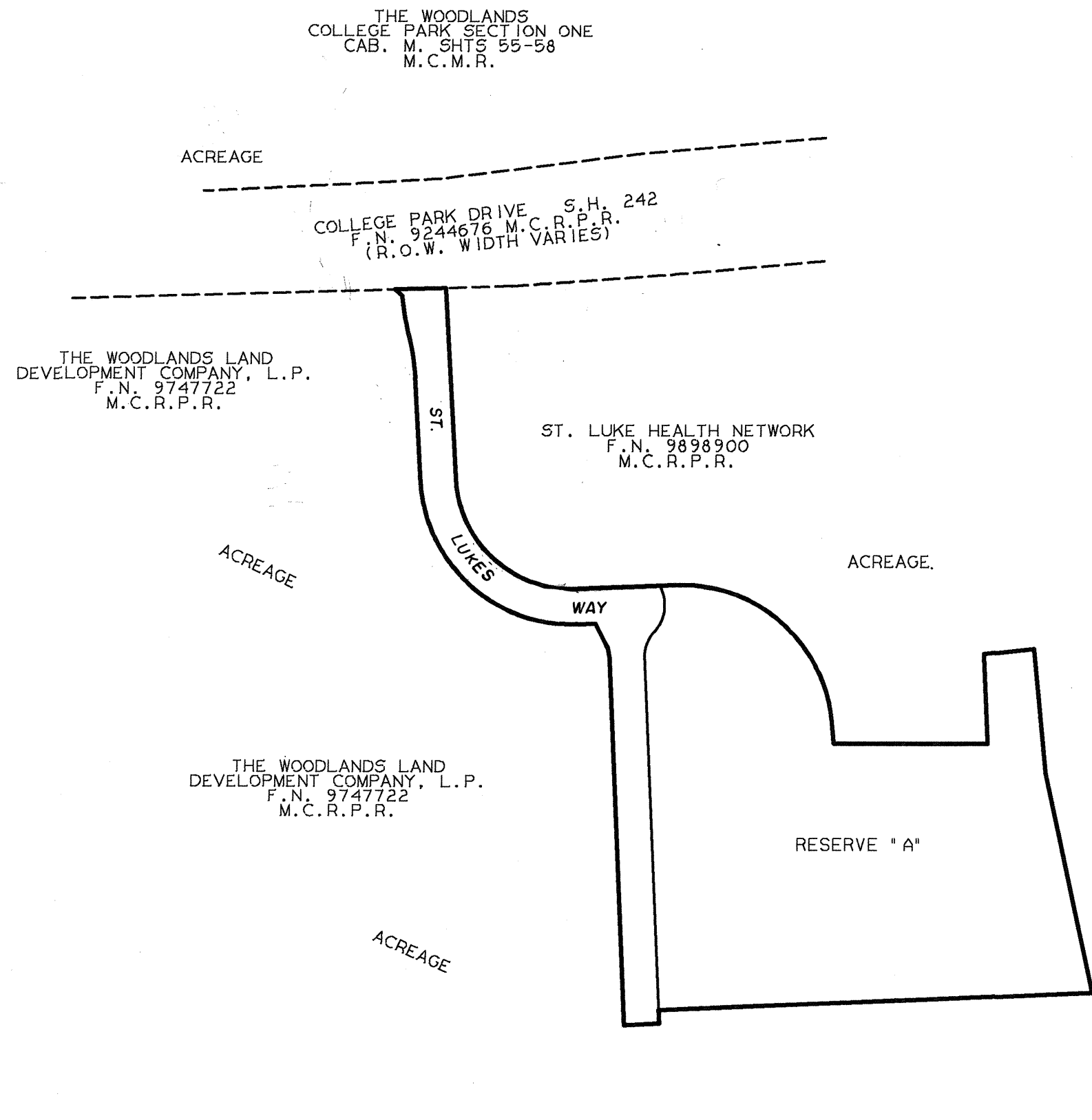

THE WOODLANDS COLLEGE PARK SEC. 5

BEING 19.95 ACRES OUT OF THE
GEORGE TAYLOR SURVEY, ABSTRACT 555
MONTGOMERY COUNTY, TEXAS

OWNER: THE WOODLANDS LAND DEVELOPMENT COMPANY, L.P.
2201 TIMBERLOCH PLACE
THE WOODLANDS, TEXAS 77380

ENGINEER:

LJA Engineering & Surveying, Inc. **LJA**
2929 Briarpark Drive Phone 713.953.5200
Suite 600 Fax 713.953.5026
Houston, Texas 77042-3703

DATE: JUNE, 2002

16.14 ACRES IN RESERVE

File # 2002094195

Abstract 5

Sheet 160

THE WOODLANDS LAND DEVELOPMENT COMPANY, L.P., ACTING HEREIN BY AND THROUGH THE WOODLANDS OPERATING COMPANY, L.P., ITS AUTHORIZED AGENT, ACTING HEREIN BY AND THROUGH ITS PRESIDENT AND CHIEF EXECUTIVE OFFICER, MICHAEL H. RICHMOND, OWNER (HEREINAFTER REFERRED TO AS "OWNER") OF THE PROPERTY SUBDIVIDED IN THE ABOVE AND FOREGOING MAP OF THE WOODLANDS COLLEGE PARK, SEC. 5 DO HEREBY MAKE SUBDIVISION OF SAID PROPERTY FOR AND ON BEHALF OF SAID THE WOODLANDS LAND DEVELOPMENT COMPANY, L.P., ACCORDING TO THE LINES, STREETS, LOTS, ALLEYS, PARKS, BUILDING LINES AND EASEMENTS THEREON SHOWN AND DESIGNATE SAID SUBDIVISION AS THE WOODLANDS COLLEGE PARK, SEC. 5 OUT OF THE GEORGE TAYLOR SURVEY, ABSTRACT 555 MONTGOMERY COUNTY, TEXAS AND ON BEHALF OF SAID THE WOODLANDS LAND DEVELOPMENT COMPANY, L.P., AND DEDICATE TO PUBLIC USE, AS SUCH, THE STREETS, ALLEYS, PARKS AND EASEMENTS SHOWN THEREON FOREVER, AND DO HEREBY WAIVE ANY CLAIMS FOR DAMAGES OCCASIONED BY THE ESTABLISHING OF GRADES AS APPROVED FOR THE STREETS AND ALLEYS DEDICATED, OR OCCASIONED BY THE ALTERATION OF THE SURFACE OF ANY PORTION OF STREETS OR ALLEYS TO CONFORM TO SUCH GRADES, AND DO HEREBY BIND OURSELVES, OUR SUCCESSORS AND ASSIGNS TO WARRANT AND FOREVER DEFEND THE TITLE TO THE LAND SO DEDICATED.

THIS IS TO CERTIFY THAT THE WOODLANDS LAND DEVELOPMENT COMPANY, L.P. ACTING HEREIN BY AND THROUGH THE WOODLANDS OPERATING COMPANY, L.P., ITS AUTHORIZED AGENT, ACTING HEREIN BY AND THROUGH ITS PRESIDENT AND CHIEF EXECUTIVE OFFICER, MICHAEL H. RICHMOND, OWNER OF THE PROPERTY SUBDIVIDED IN THE ABOVE AND FOREGOING MAP OF THE WOODLANDS COLLEGE PARK, SEC. 5 HAVE COMPLETED OR WILL COMPLY WITH ALL REGULATIONS HERETOFORE ON FILE WITH THE MONTGOMERY COUNTY ENGINEER AND ADOPTED BY THE COMMISSIONERS' COURT OF MONTGOMERY COUNTY, TEXAS.

FURTHER, OWNER HAS DEDICATED AND BY THESE PRESENTS DOES DEDICATE TO THE PUBLIC FOR PUBLIC UTILITY PURPOSES FOREVER UNOBSTRUCTED AERIAL EASEMENTS. THE AERIAL EASEMENTS SHALL EXTEND HORIZONTALLY AN ADDITIONAL ELEVEN FEET, SIX INCHES (11' 6") FOR TEN FEET (10' 0") PERIMETER GROUND EASEMENTS OR FIVE FEET, SIX INCHES (5' 6") FOR SIXTEEN FEET (16' 0") PERIMETER GROUND EASEMENTS, FROM A PLANE SIXTEEN FEET (16' 0") ABOVE GROUND LEVEL UPWARD, LOCATED ADJACENT TO AND ADJOINING SAID PUBLIC UTILITY EASEMENTS THAT ARE DESIGNATED WITH AERIAL EASEMENTS (U.E. & A.E.) AS INDICATED AND DEPICTED HEREON, WHEREBY THE AERIAL EASEMENT TOTALS TWENTY ONE FEET, SIX INCHES (21' 6") IN WIDTH.

FURTHER, OWNER HAS DEDICATED AND BY THESE PRESENTS DOES DEDICATE TO THE PUBLIC FOR PUBLIC UTILITY PURPOSES FOREVER UNOBSTRUCTED AERIAL EASEMENTS. THE AERIAL EASEMENTS SHALL EXTEND HORIZONTALLY AN ADDITIONAL TEN FEET (10' 0") FOR TEN FEET (10' 0") BACK-TO-BACK GROUND EASEMENTS OR SEVEN FEET (7' 0") FOR SIXTEEN FEET (16' 0") BACK-TO-BACK GROUND EASEMENTS, FROM A PLANE SIXTEEN FEET (16' 0") ABOVE GROUND LEVEL UPWARD, LOCATED ADJACENT TO BOTH SIDES AND ADJOINING SAID PUBLIC UTILITY EASEMENTS THAT ARE DESIGNATED WITH AERIAL EASEMENTS (U.E. & A.E.) AS INDICATED AND DEPICTED HEREON, WHEREBY THE AERIAL EASEMENT TOTALS THIRTY FEET (30' 0") IN WIDTH.

FURTHER, OWNER DOES HEREBY DEDICATE FOREVER TO THE PUBLIC A STRIP OF LAND A MINIMUM FIFTEEN (15' - 0") FEET WIDE ON EACH SIDE OF THE CENTERLINE, OF ANY AND OF ALL GULLIES, RAVINES, DRAWS, SLOUGHS, OR OTHER NATURAL DRAINAGE COURSES LOCATED IN THE SAID SUBDIVISION, AS EASEMENTS FOR DRAINAGE PURPOSES, GIVING MONTGOMERY COUNTY AND/OR ANY OTHER PUBLIC AGENCY THE RIGHT TO ENTER UPON SAID EASEMENTS AT ANY AND ALL TIMES FOR THE PURPOSE OF CONSTRUCTING AND/OR MAINTAINING DRAINAGE WORK AND/OR STRUCTURES.

FURTHER, ALL OF THE PROPERTY SUBDIVIDED IN THE ABOVE AND FOREGOING MAP SHALL BE RESTRICTED IN ITS USE, WHICH RESTRICTIONS SHALL RUN WITH THE TITLE TO THE PROPERTY, AND SHALL BE ENFORCEABLE, AT THE OPTION OF MONTGOMERY COUNTY, BY MONTGOMERY COUNTY OR ANY CITIZEN THEREOF, BY INJUNCTION, AS FOLLOWS:

1. THAT DRAINAGE OF SEPTIC TANKS INTO ROAD, STREET, ALLEY, OR OTHER PUBLIC DITCHES, EITHER DIRECTLY OR INDIRECTLY, IS STRICTLY PROHIBITED.
2. DRAINAGE STRUCTURES UNDER PRIVATE DRIVEWAYS SHALL HAVE A NET DRAINAGE OPENING AREA OF SUFFICIENT SIZE TO PERMIT THE FREE FLOW OF WATER WITHOUT BACKWATER, AND SHALL BE A MINIMUM OF ONE AND THREE QUARTERS (1-3/4) SQUARE FEET (18" DIAMETER PIPE CULVERT).

IN TESTIMONY WHEREOF THE WOODLANDS OPERATING COMPANY, L.P., A TEXAS LIMITED PARTNERSHIP ACTING IN ITS CAPACITY AS AUTHORIZED AGENT OF THE WOODLANDS LAND DEVELOPMENT COMPANY, L.P., A TEXAS LIMITED PARTNERSHIP, HAS CAUSED THESE PRESENTS TO BE SIGNED BY MICHAEL H. RICHMOND, ITS PRESIDENT AND CHIEF EXECUTIVE OFFICER, THEREUNTO AUTHORIZED, THIS THE 25th DAY OF July, 2002.

THE WOODLANDS LAND DEVELOPMENT COMPANY, L.P.
A TEXAS LIMITED PARTNERSHIP

BY: THE WOODLANDS OPERATING COMPANY, L.P.
A TEXAS LIMITED PARTNERSHIP,
ITS AUTHORIZED AGENT

NAME: Michael H. Richmond
TITLE: PRESIDENT AND
CHIEF EXECUTIVE OFFICER

FILED FOR RECORD

2002 SEP 11 AM 10:39

Mark Turnbull
COUNTY CLERK
MONTGOMERY COUNTY, TEXAS

STATE OF TEXAS
COUNTY OF MONTGOMERY

BEFORE ME, THE UNDERSIGNED AUTHORITY, ON THIS DAY PERSONALLY APPEARED MICHAEL H. RICHMOND, PRESIDENT AND CHIEF EXECUTIVE OFFICER OF THE WOODLANDS OPERATING COMPANY, L.P., A TEXAS LIMITED PARTNERSHIP, AUTHORIZED AGENT OF THE WOODLANDS LAND DEVELOPMENT COMPANY, L.P., A TEXAS LIMITED PARTNERSHIP, KNOWN TO ME TO BE THE PERSON WHOSE NAME IS SUBSCRIBED TO THE FOREGOING INSTRUMENT AND ACKNOWLEDGED TO ME THAT HE EXECUTED THE SAME FOR THE PURPOSES AND CONSIDERATIONS THEREIN EXPRESSED, AND IN THE CAPACITY THEREIN AND HEREIN SET OUT AND AS AN ACT AND DEED OF SAID LIMITED PARTNERSHIP.

GIVEN UNDER MY HAND AND SEAL OF OFFICE, THIS 25th DAY OF July, 2002.

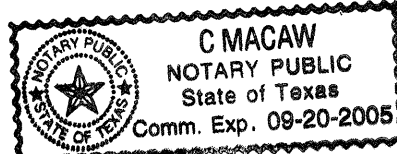

NOTARY PUBLIC IN AND FOR THE STATE OF TEXAS

MY COMMISSION EXPIRES: 9-20-05

file # 2002094195

Cabinet 5

Sheet 161

I, STEPHEN P. MATOVICH, AM REGISTERED UNDER THE LAWS OF THE STATE OF TEXAS TO PRACTICE THE PROFESSION OF SURVEYING AND HEREBY CERTIFY THAT THE ABOVE SUBDIVISION IS TRUE AND CORRECT, WAS PREPARED FROM AN ACTUAL SURVEY OF THE PROPERTY MADE UNDER MY SUPERVISION ON THE GROUND, THAT THE ELEVATION BENCHMARK REFLECTED ON THE FACE OF THE PLAT WAS ESTABLISHED AS REQUIRED BY REGULATION, THAT ALL CORNERS AND ANGLE POINTS OF THE BOUNDARIES OF THE ORIGINAL TRACT TO BE SUBDIVIDED OF REFERENCE HAVE BEEN MARKED WITH IRON RODS HAVING A DIAMETER OF NOT LESS THAN FIVE-EIGHTHS OF AN INCH (5/8") AND A LENGTH OF NOT LESS THAN THREE FEET (3'), AND THAT THE PLAT BOUNDARY CORNERS HAVE BEEN TIED TO THE NEAREST SURVEY CORNER.



Stephen P. Matovich 7-03-02
NAME: STEPHEN P. MATOVICH
TEXAS REGISTRATION: 5347

THIS IS TO CERTIFY THAT THE HOUSTON PLANNING COMMISSION OF THE CITY OF HOUSTON, TEXAS HAS APPROVED THIS PLAT AND SUBDIVISION OF THE WOODLANDS COLLEGE PARK, SEC. 5 IN CONFORMANCE WITH THE LAWS OF THE STATE OF TEXAS AND THE ORDINANCES OF THE CITY OF HOUSTON, AS SHOWN HEREON AND AUTHORIZED THE RECORDING OF THIS PLAT, THIS 16th DAY OF August, 2002.

BY: M. Marvin Katz CHAIRMAN
BY: Robert M. Litke SECRETARY

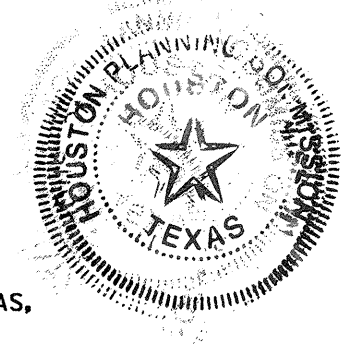

I, MARK J. MOONEY, P.E., COUNTY ENGINEER OF MONTGOMERY COUNTY, TEXAS, DO HEREBY CERTIFY THAT THE PLAT OF THIS SUBDIVISION COMPLIES WITH ALL OF THE EXISTING RULES AND REGULATIONS OF THIS OFFICE AS ADOPTED BY THE MONTGOMERY COUNTY COMMISSIONERS' COURT.

I FURTHER CERTIFY THAT THE PLAT OF THIS SUBDIVISION COMPLIES WITH REQUIREMENTS FOR INTERNAL SUBDIVISION DRAINAGE AS ADOPTED BY THE MONTGOMERY COUNTY COMMISSIONERS' COURT. HOWEVER, NO CERTIFICATION IS HEREBY GIVEN AS TO THE EFFECT OF DRAINAGE FROM THIS SUBDIVISION TO THE INTERCEPTING DRAINAGE ARTERY OR PARENT STREAM OR ANY OTHER AREA OF SUBDIVISION WITHIN THE WATERSHED.

Mark J. Mooney
MARK J. MOONEY, P.E.,
MONTGOMERY COUNTY ENGINEER

APPROVED BY THE COMMISSIONERS' COURT OF MONTGOMERY COUNTY, TEXAS, THIS 9th DAY OF September, 2002.

Mike Meador MIKE MEADOR COMMISSIONER, PRECINCT 1
Craig Doyal CRAIG DOYAL COMMISSIONER, PRECINCT 2

Alan B. Sadler
ALAN B. SADLER
COUNTY JUDGE

Ed Chance
ED CHANCE
COMMISSIONER, PRECINCT 3

Ed Rinehart
ED RINEHART
COMMISSIONER, PRECINCT 4

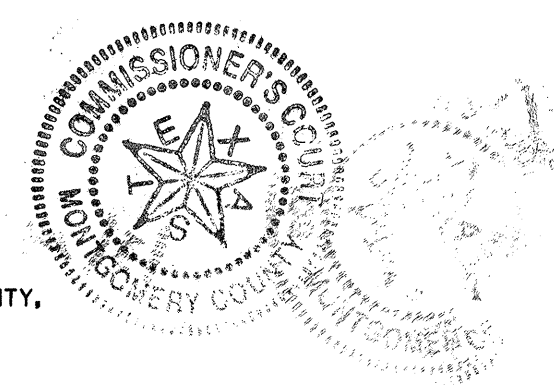

THE STATE OF TEXAS
COUNTY OF MONTGOMERY

I, MARK TURNBULL, CLERK OF THE COUNTY COURT OF MONTGOMERY COUNTY, TEXAS, DO HEREBY CERTIFY THAT THE WITHIN INSTRUMENT WITH ITS CERTIFICATE OF AUTHENTICATION WAS FILED FOR REGISTRATION IN MY OFFICE ON September 9 2002 AT 9:30 O' CLOCK A.M. AND DULY RECORDED ON 9-11-02, 2002 AT 10:39 O' CLOCK A.M., IN CABINET 5, SHEETS 160-163, OF RECORD OF FOR SAID COUNTY.

WITNESS MY HAND AND SEAL OF OFFICE, AT CONROE, MONTGOMERY COUNTY, TEXAS, THE DAY AND DATE LAST ABOVE WRITTEN.

Mark Turnbull
MARK TURNBULL, CLERK OF THE COUNTY COURT
MONTGOMERY COUNTY, TEXAS

BY: Alonso Johnson
DEPUTY

DANIEL F. WHILLDEN A-640
F.D. MAY A-388

P.O.C.
X = 3,116,150.4698
Y = 880,390.7364

JAMES MCCAMBERIDGE A-390

COLLEGE PARK DRIVE S.H. 242
F.N. 9244676 M.C.R.P.R.
(R.O.W. WIDTH VARIES)

P.O.B.
X = 3,117,842.8293
Y = 879,847.4362

THE WOODLANDS LAND
DEVELOPMENT COMPANY, L.P.
F.N. 9747722
M.C.R.P.R.

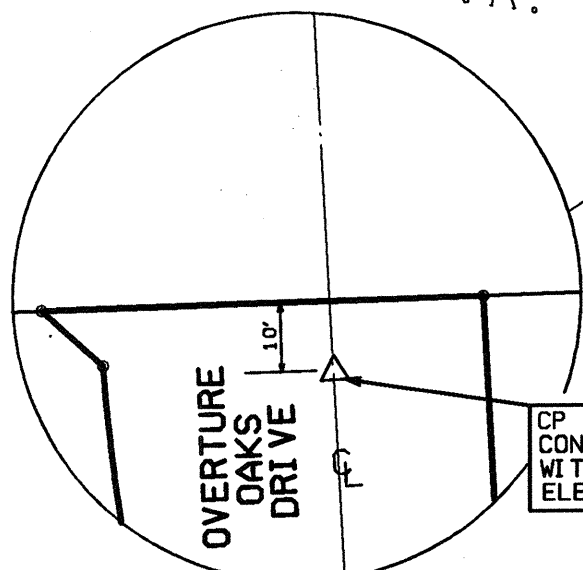

NOT TO SCALE

CP 5
CONC. MON.
WITH BRASS DISC
ELEV. = 129.81

ACREAGE

THE WOODLANDS LAND
DEVELOPMENT COMPANY, L.P.
F.N. 9747722
M.C.R.P.R.

ACREAGE

ACREAGE

RESTRICTED RESERVE "A"
16.14 AC. 702,930 SQ. FT.
RESTRICTED TO COMMERCIAL USE

1' RESERVE (SEE NOTE 11)

OWNER: THE WOODLANDS LAND DEVELOPMENT COMPANY, L.P.
2201 TIMBERLOCH PLACE
THE WOODLANDS, TEXAS 77380

SCALE: 1"=100'

IH 45



INTERSTATE HIGHWAY 45
(R.O.W. VARIES)

THE WOODLANDS
COLLEGE PARK
SEC. 5
SHEET 3 OF 4

File # 2002094195

Cabinet S

Sheet 162

GENERAL NOTES

1. D. E. INDICATES DRAINAGE EASEMENT. DRAINAGE EASEMENT SHALL HEREBY BE RESTRICTED TO KEEP CLEAR OF FENCES, BUILDING, PLANTING AND OBSTRUCTIONS TO THE OPERATIONS AND MAINTENANCE OF THE DRAINAGE FACILITY.
2. B. L. INDICATES BUILDING LINES.
3. S. S. E. INDICATES SANITARY SEWER EASEMENT.
4. S. T. M. S. E. INDICATES STORM SEWER EASEMENT. MAINTAIN DRAINAGE BENEATH FENCES (MIN. 5' SQ. FT.) AND AROUND OTHER OBSTRUCTIONS THAT WOULD OTHERWISE INTERRUPT THE OPERATIONS AND MAINTENANCE OF THE DRAINAGE FACILITY.
5. W. L. E. INDICATES WATER LINE EASEMENT.
6. U. E. INDICATES UTILITY EASEMENT.
7. ALL UTILITY EASEMENTS EXTEND EQUAL DISTANCE EITHER SIDE OF PROPERTY LINES UNLESS OTHERWISE NOTED.
8. THIS PLAT IS NOT TIED INTO THE OFFICIAL CITY OF HOUSTON SURVEY SYSTEM IN COMPLIANCE WITH ORDINANCE NO. 69-1978, BECAUSE A CITY OF HOUSTON SURVEY MARKER HAS NOT BEEN ESTABLISHED WITHIN 2,000 FEET OF THIS PROPERTY.
9. ALL BEARINGS REFERENCED TO THE 1927 TEXAS STATE PLANE COORDINATE SYSTEM SOUTH CENTRAL ZONE.
10. UNLESS OTHERWISE INDICATED, THE BUILDING LINES (B.L.), WHETHER ONE OR MORE, SHOWN ON THIS SUBDIVISION PLAT ARE ESTABLISHED TO EVIDENCE COMPLIANCE WITH THE APPLICABLE PROVISIONS OF CHAPTER 42, CODE OF ORDINANCES, CITY OF HOUSTON, TEXAS, IN EFFECT AT THE TIME THIS PLAT WAS APPROVED, WHICH MAY BE AMENDED FROM TIME TO TIME.
11. 1' ONE-FOOT RESERVE DEDICATED TO THE PUBLIC IN FEE AS A BUFFER SEPARATION BETWEEN THE SIDE OR END OF STREETS WHERE SUCH STREETS ADJACENT ACREAGE TRACTS, THE CONDITION OF SUCH DEDICATION BEING THAT WHEN THE ADJACENT PROPERTY IS SUBDIVIDED IN A RECORDED PLAT, THE ONE-FOOT RESERVE SHALL THEREUPON BECOME VESTED IN THE PUBLIC FOR STREET RIGHT-OF-WAY PURPOSES AND THE FEE TITLE THERETO SHALL REVERT TO AND REVEST IN THE DEDICATOR, HIS HEIRS, ASSIGNS OR SUCCESSORS.
12. THE FOLLOWING EASEMENTS AND FOREST PRESERVES NOT SHOWN ON THE PLAT, EXISTS ON PROPERTY:
 - 5' & 10' U.E. : F.N. 9357930, F.N. 2001-055917, F.N. 2001-055920
 - 10' U.E. : F.N. 2001-055918
 - FOREST PRESERVE : F.N. 2001-055918

CURVE TABLE						
CURVE	RADIUS	TANGENT	CHORD	ARC	DELTA	CHORD BEARING
1	80.00	17.61	34.39	34.66	24°49'13"	N-14-44-24-W
2	340.00	335.60	477.69	529.64	89°15'14"	N-47-42-07-W
3	500.00	50.10	99.71	99.87	11°26'40"	N-08-47-50-W
4	500.00	44.56	88.77	88.89	10°11'09"	N-09-25-36-W
5	260.00	256.64	365.29	405.02	89°15'14"	S-47-42-07-E
6	340.00	320.49	466.43	514.00	86°37'01"	S-49-01-13-E
7	500.00	50.10	99.71	99.87	11°26'40"	N-08-47-50-W
8	500.00	44.56	88.77	88.89	10°11'09"	N-09-25-36-W
9	90.00	64.78	105.15	112.29	71°29'13"	S-07-01-36-W
10	80.00	33.22	61.36	62.97	45°05'57"	S-20-13-14-W
11	80.00	33.22	61.36	62.97	45°05'57"	N-20-13-14-E
12	90.00	64.78	105.15	112.29	71°29'13"	N-07-01-36-E
13	85.00	85.01	120.22	133.53	90°00'24"	N-47-19-56-W
14	300.00	296.12	421.49	467.33	89°15'14"	N-47-42-07-W

LINE TABLE		
LINE	BEARING	DISTANCE
1	N-27-09-03-W	51.48
2	S-87-39-52-W	42.96
3	N-48-04-30-W	21.57
4	S-05-42-44-E	55.67
5	S-02-19-44-E	30.74
6	S-87-40-16-W	80.00
7	N-48-04-30-W	21.57
8	N-87-40-16-E	37.16
9	S-87-39-52-W	26.97
10	N-42-40-20-E	35.21

RESERVES			
RESERVE	ACREAGE	SQ. FT.	TYPE
A	16.14	702,930	RESTRICTED TO COMMERCIAL USE
TOTAL	16.14	702,930	-----

OWNER: THE WOODLANDS LAND DEVELOPMENT COMPANY, L. P.
 2201 TIMBERLOCH PLACE
 THE WOODLANDS, TEXAS 77380

THE WOODLANDS
 COLLEGE PARK
 SEC. 5
 SHEET 4 OF 4

File # 2002094195

Cabinet S

Sheet 163